



University of Northern Iowa



Strategic Plan



Capital Plan

Campus Plan

Strategic Goals Supported

- Foster a supportive living, learning and working environment with services and programs that promote individual well being and organizational effectiveness.
 - Maintain safe environments, conditions and equipment.
- Continue to improve capital, physical and informational resources at the University.
 - Enhance technologically appropriate teaching and learning facilities and equipment.
- Promote a university culture characterized by diversity, collegiality, mutual respect, organizational effectiveness and shared responsibility.
 - Maintain a safe and supportive working and living environment characterized by services and programs that promote individual well-being and organizational effectiveness.
- Provide and maintain appropriate resources for effective and efficient University operations.
 - Upgrade, construct and maintain buildings grounds and equipment.

Comprehensive Campus Plan
University of Northern Iowa

Concentric Zones

■ Campus Buildings in 1968

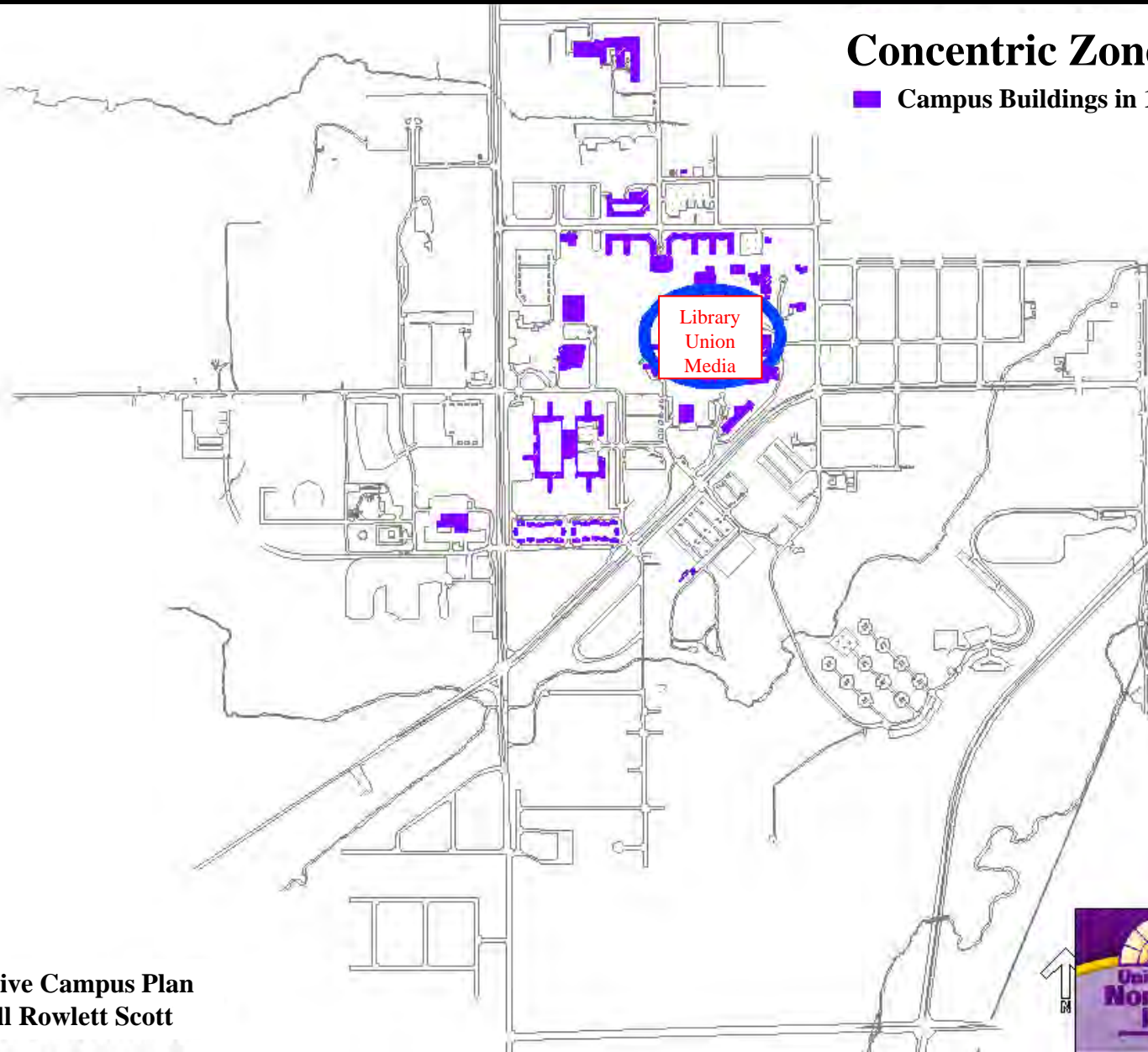

Comprehensive Campus Plan
1968 Caudill Rowlett Scott



Concentric Zones

■ Campus Buildings in 1968

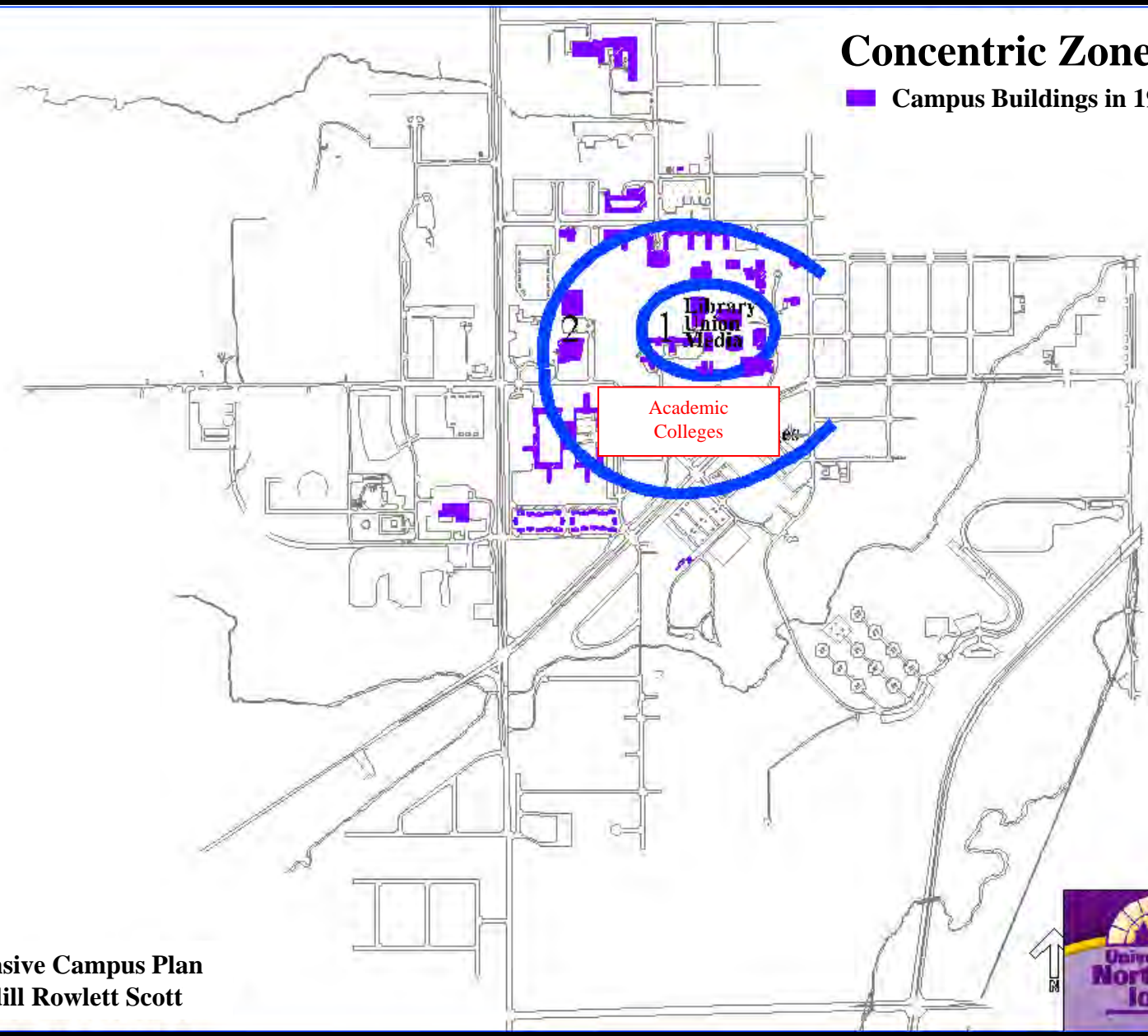

Comprehensive Campus Plan
1968 Caudill Rowlett Scott



Concentric Zones

■ Campus Buildings in 1968

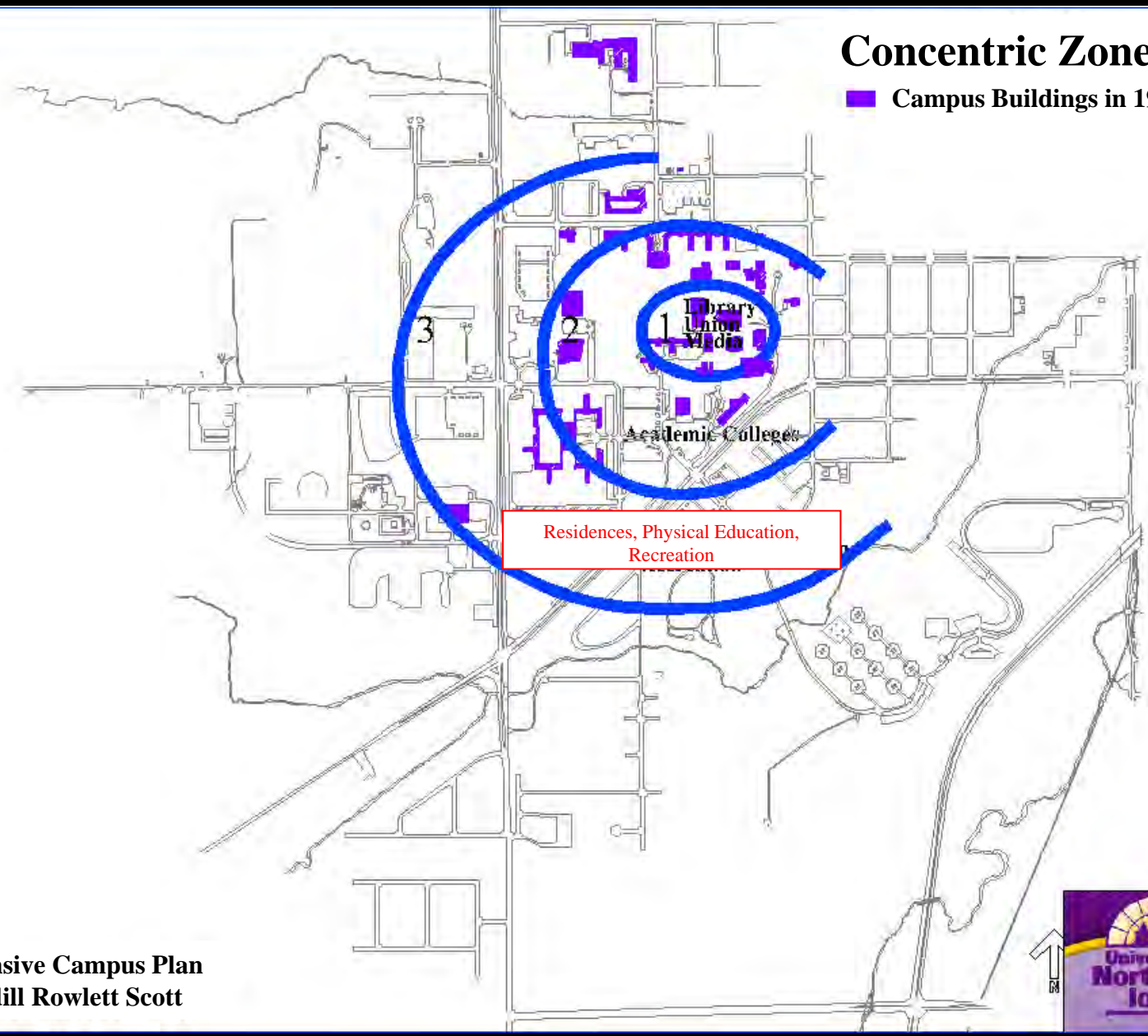

Comprehensive Campus Plan
1968 Caudill Rowlett Scott



Concentric Zones

■ Campus Buildings in 1968

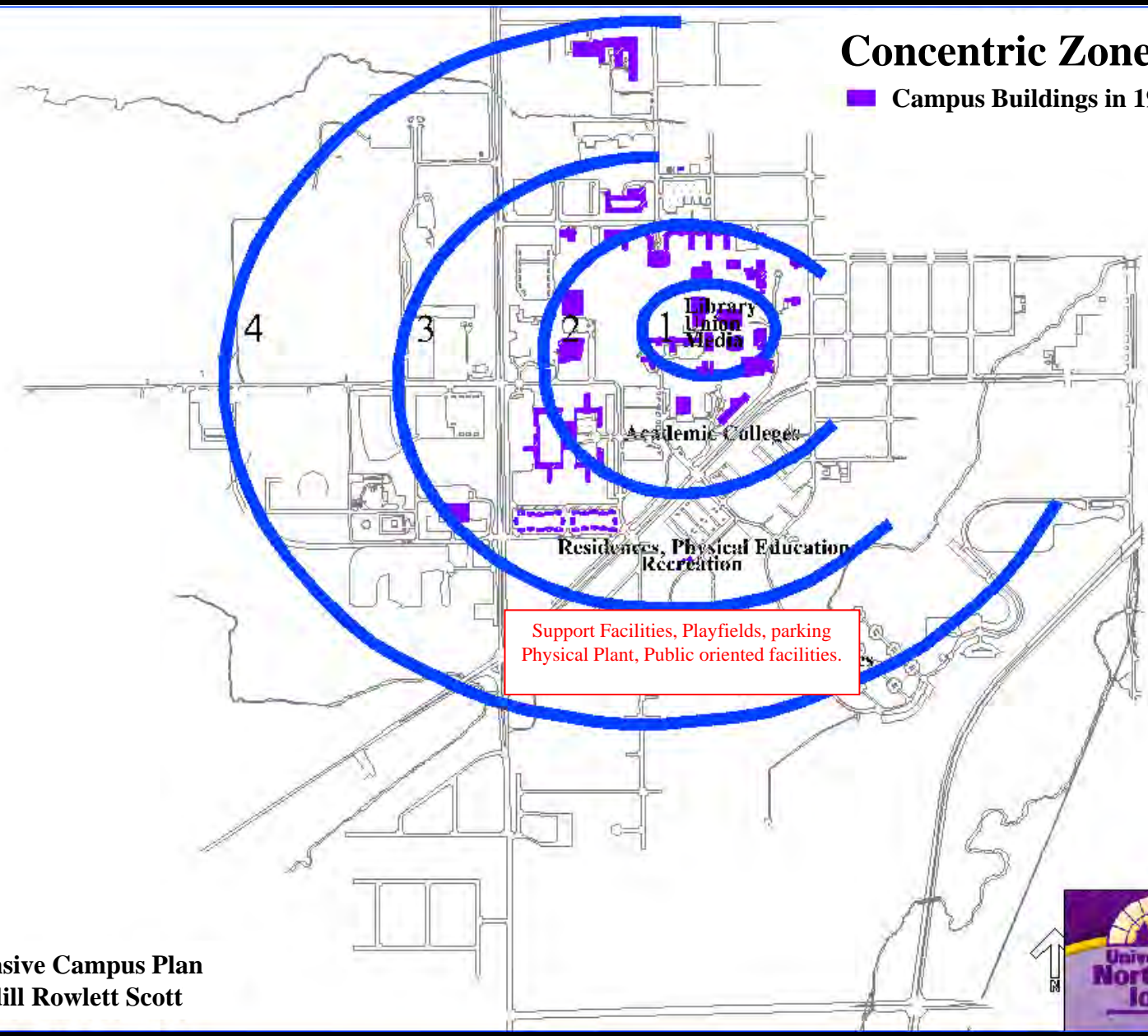

Comprehensive Campus Plan
1968 Caudill Rowlett Scott



Concentric Zones

■ Campus Buildings in 1968

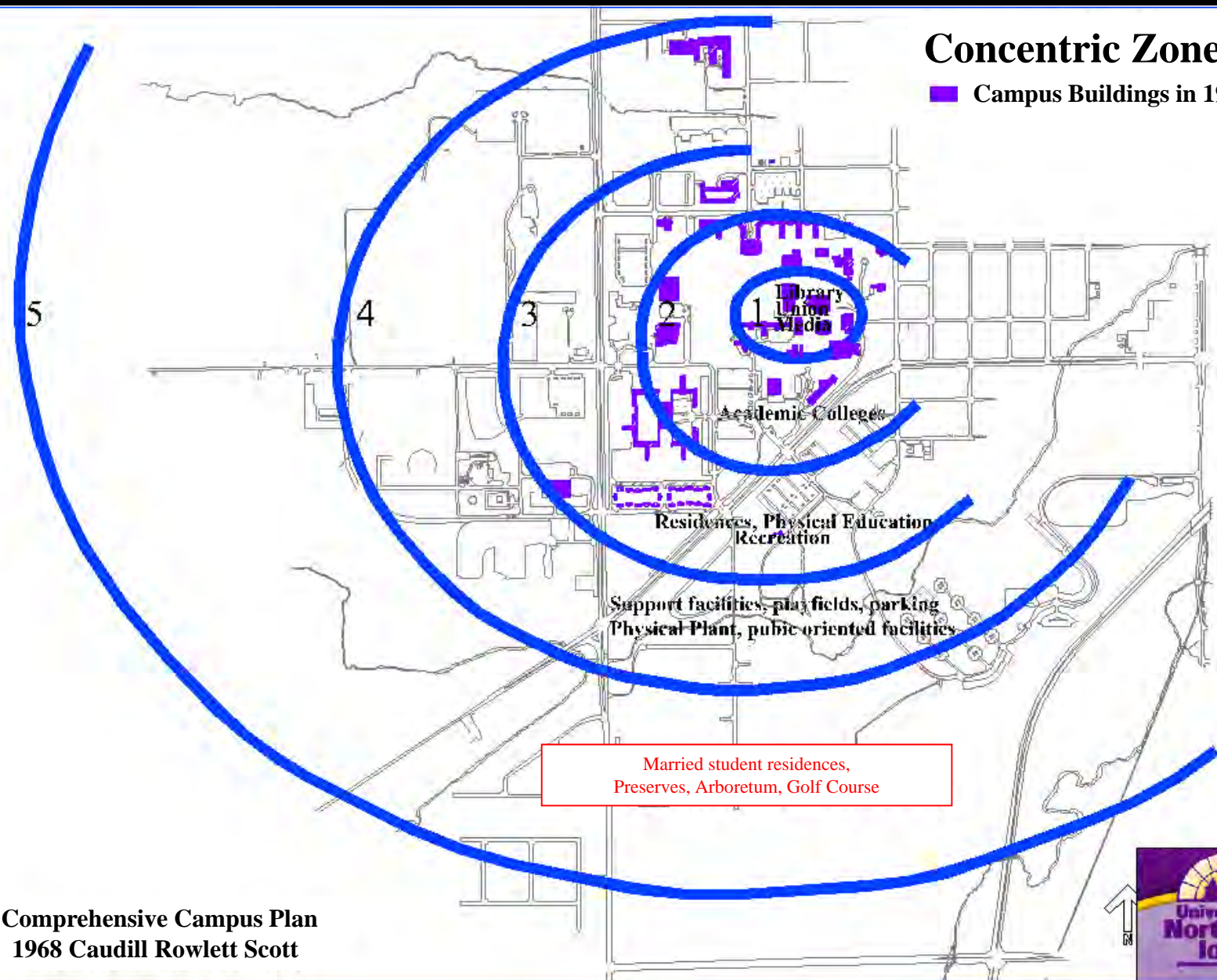

Comprehensive Campus Plan
1968 Caudill Rowlett Scott



Concentric Zones

-  Campus Buildings in 1968
-  Campus Buildings in 2004

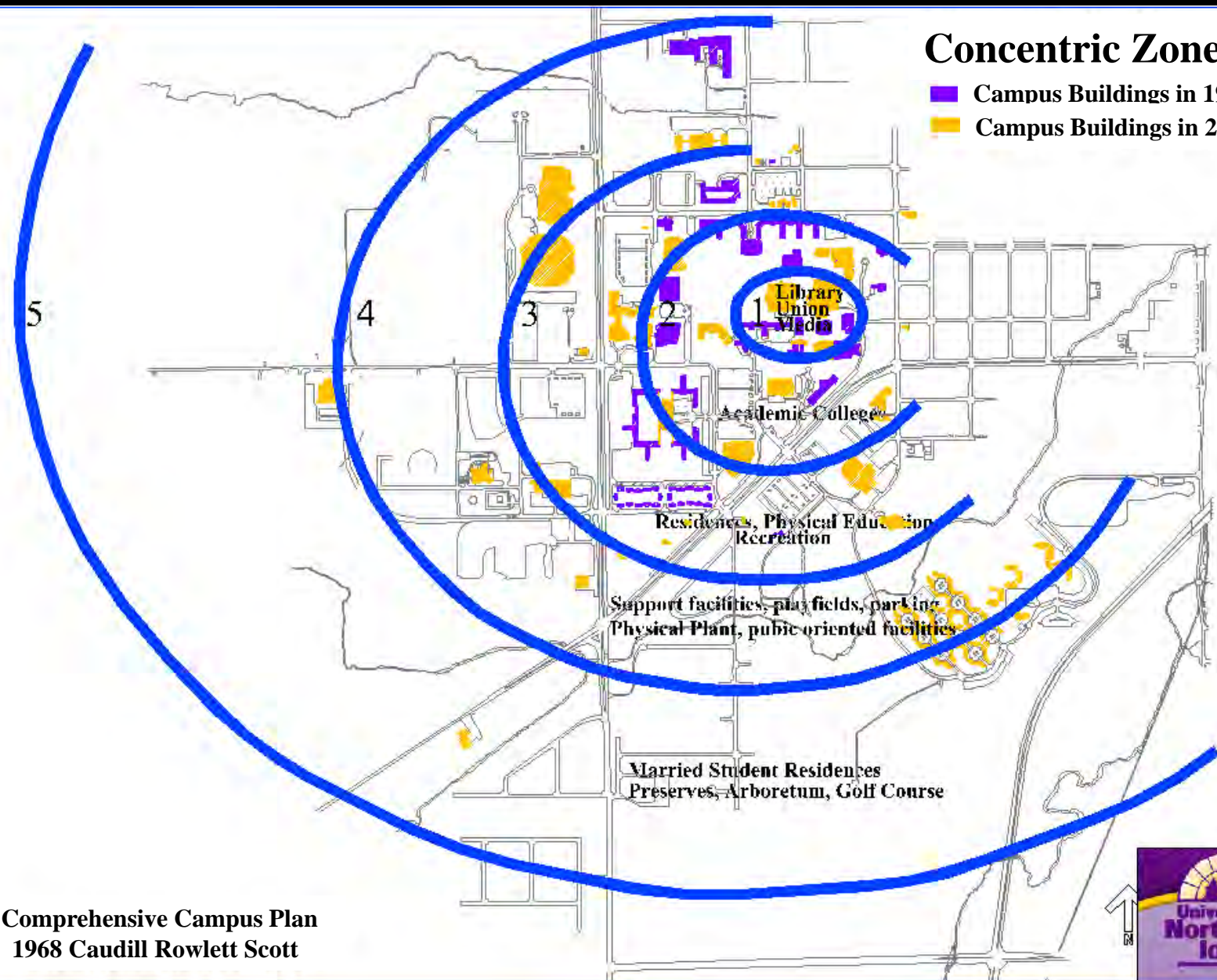

Comprehensive Campus Plan
1968 Caudill Rowlett Scott



UNI Campus Boundary

- Campus Boundary
- Land of Interest to Institution
- Land Purchased or Sold

UNI Campus Boundary

— Campus Boundary 2004 (934 Acres)

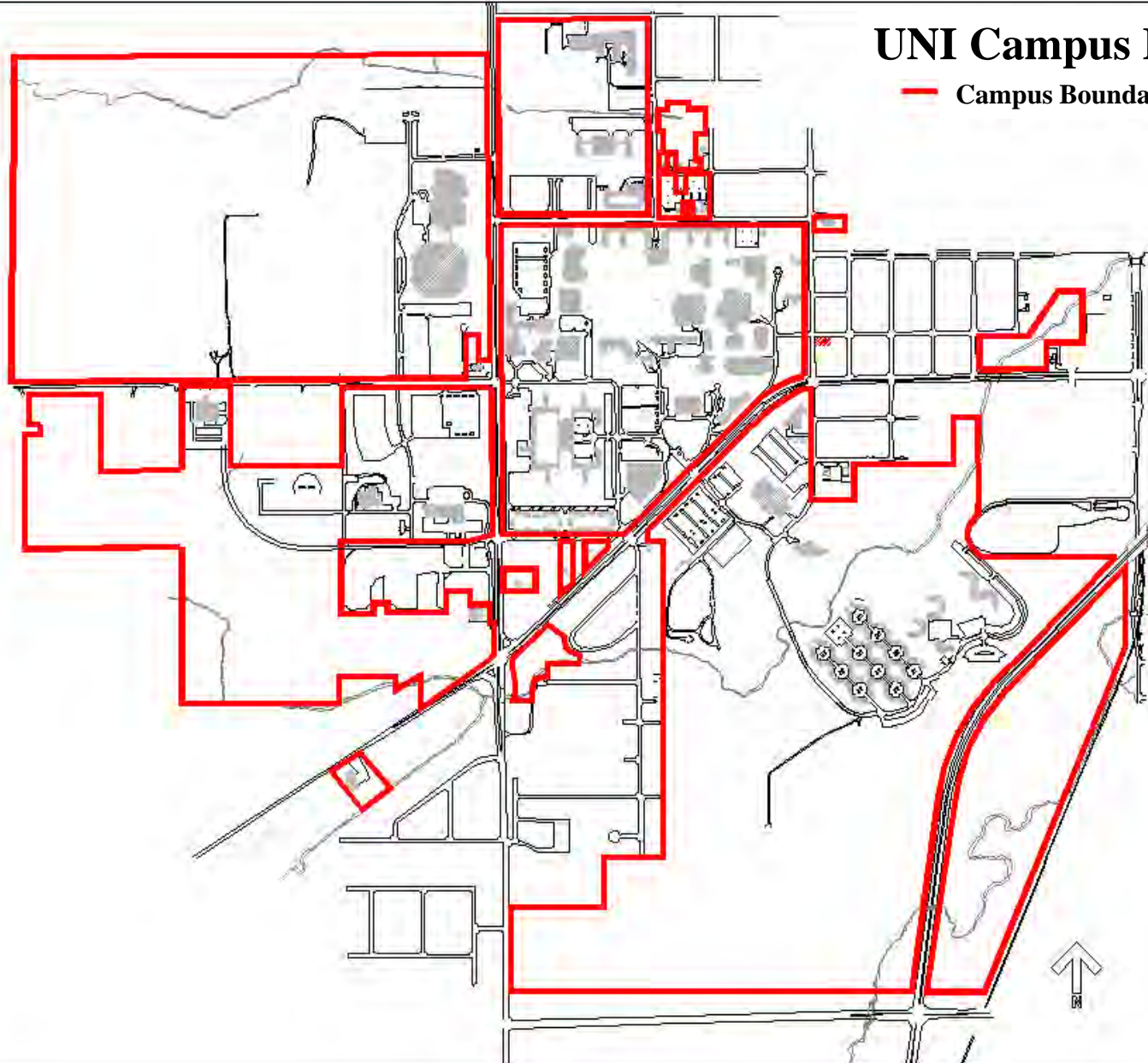

UNI Campus Boundary

- Campus Boundary 2004 (934 Acres)
- ▒ Land of Interest

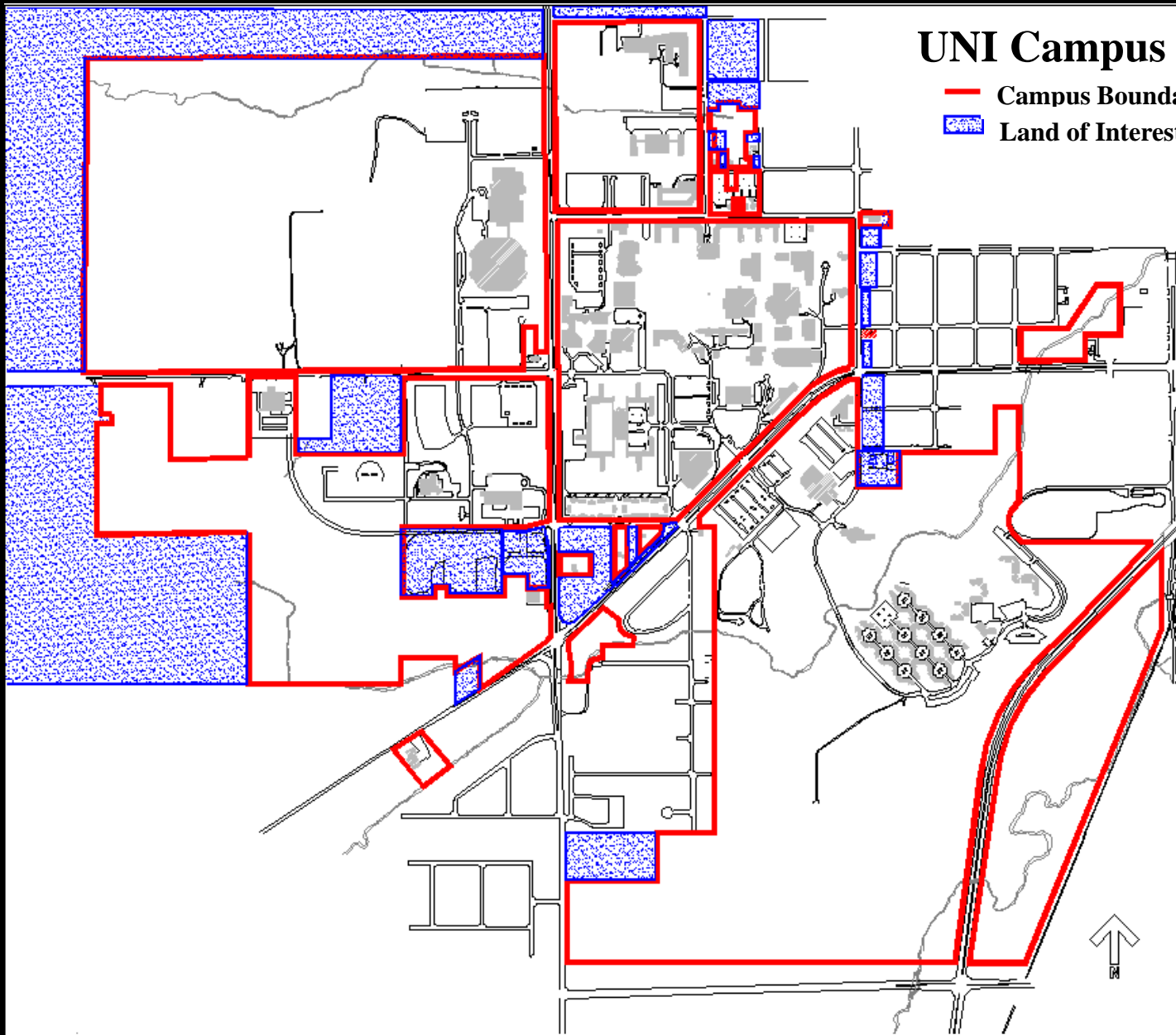

UNI Campus Boundary

- Campus Boundary 2004 (934 Acres)
- Land of Interest
- Land sold since 2000
- Land purchased since 2000

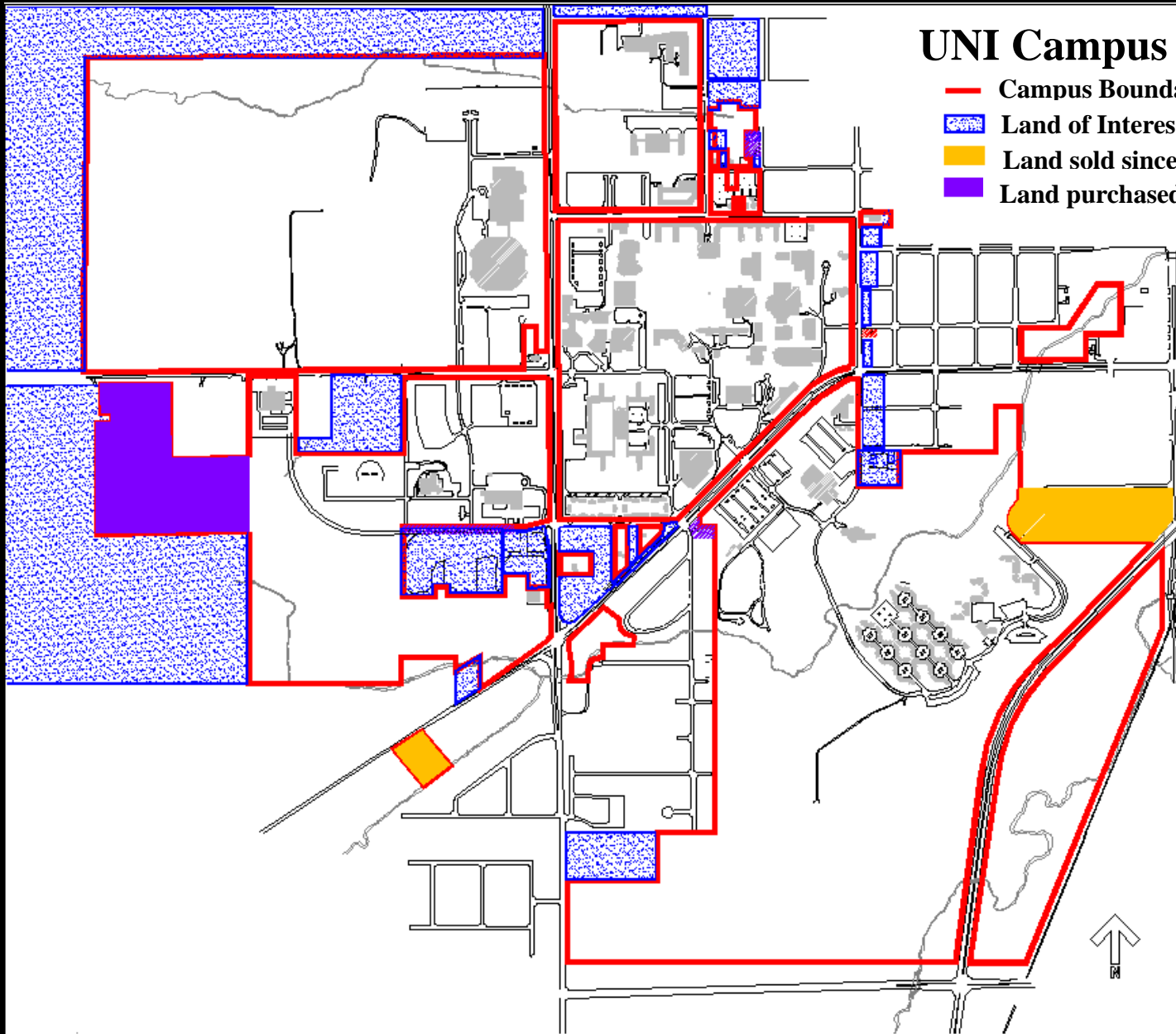

Land Use Studies

Land Use Studies

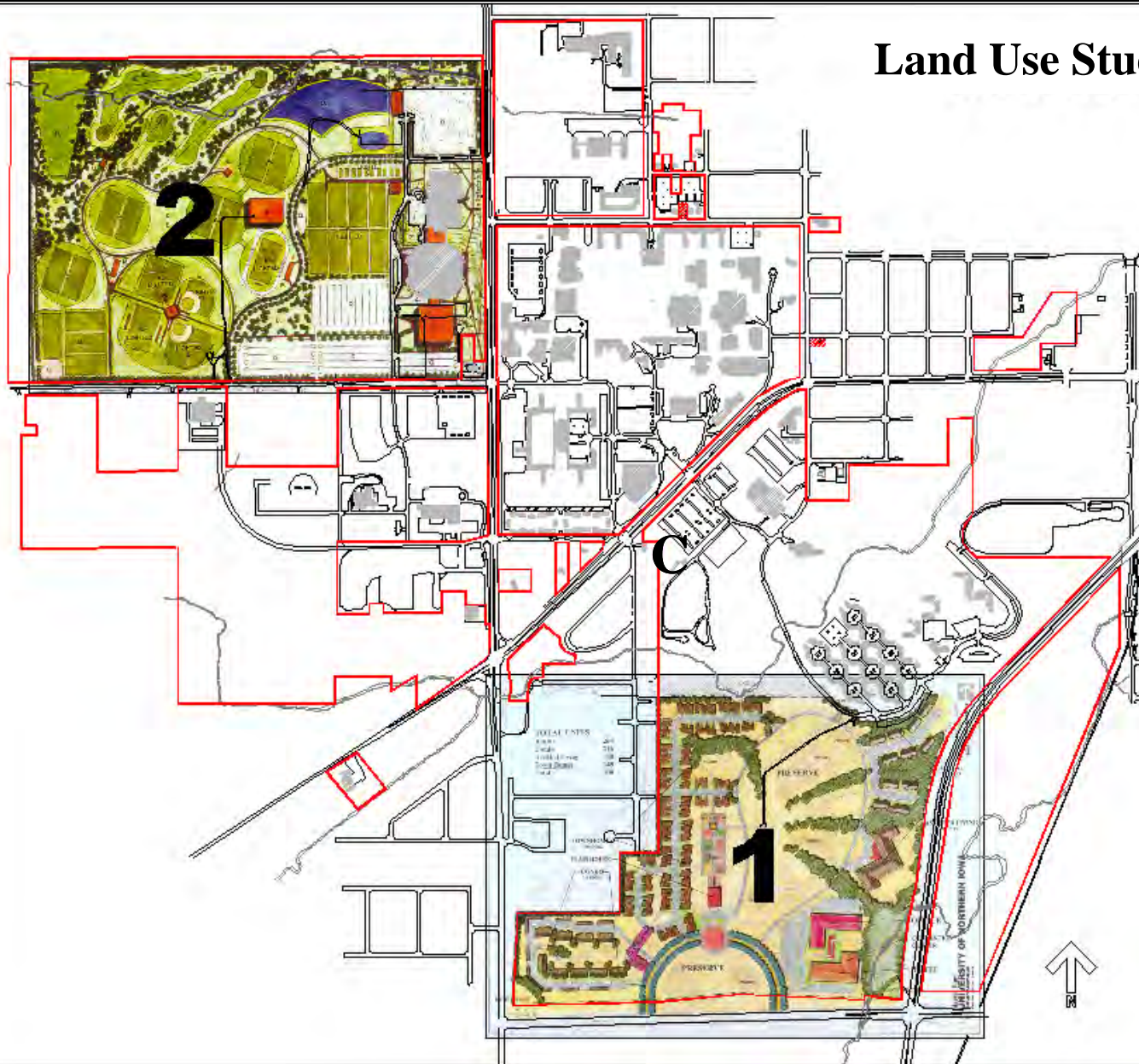

Potential Building Sites

Potential Building Sites

■ Potential Building Sites 2000

■ Existing Campus Buildings

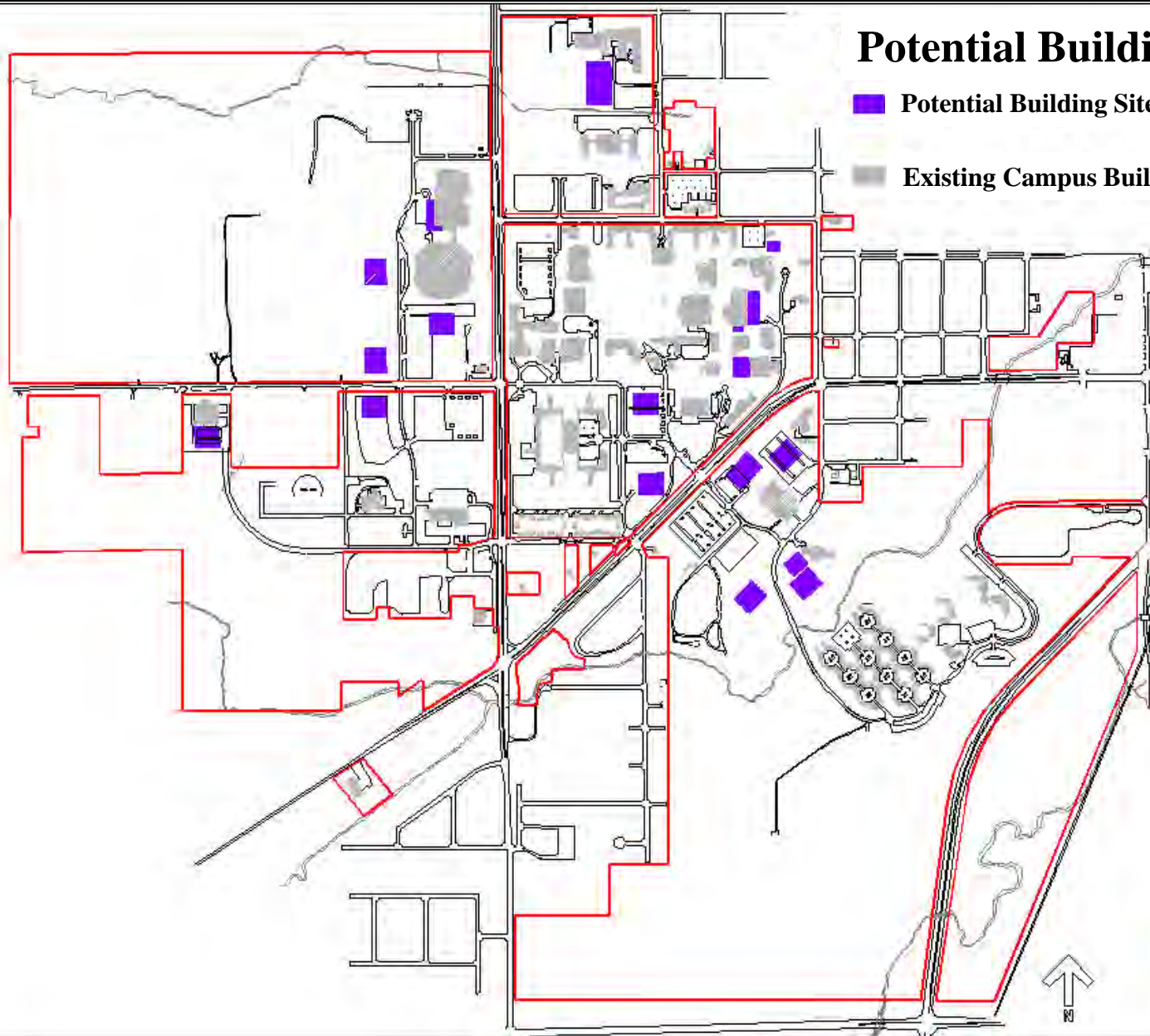

Potential Building Sites

-  Potential Building Sites 2000
-  Building Sites developed since 2000
-  Existing Campus Buildings

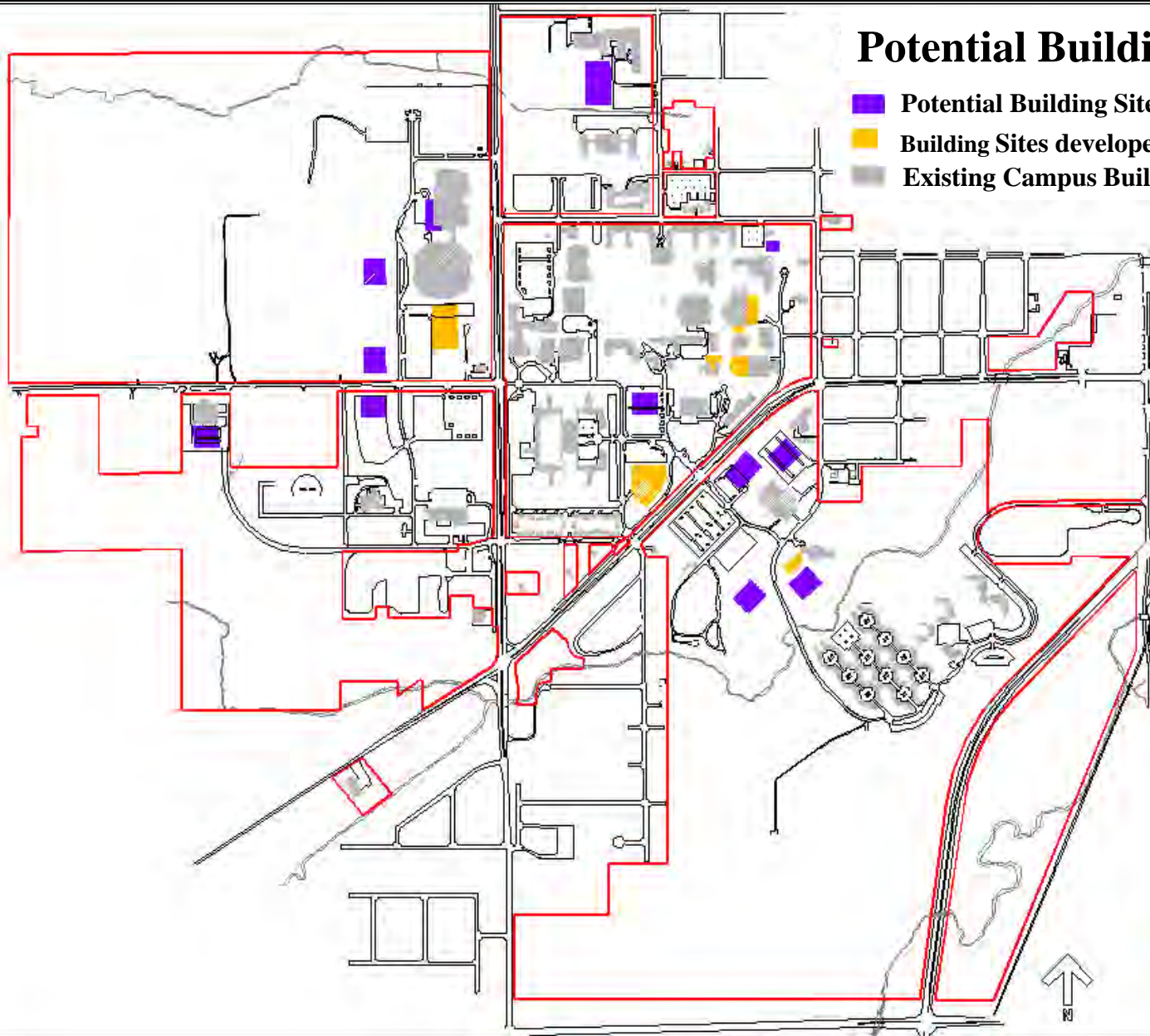

Long-Range Pedestrian Circulation Plan

Pedestrian Circulation Plan

— Pedestrian Circulation Plan (long range)

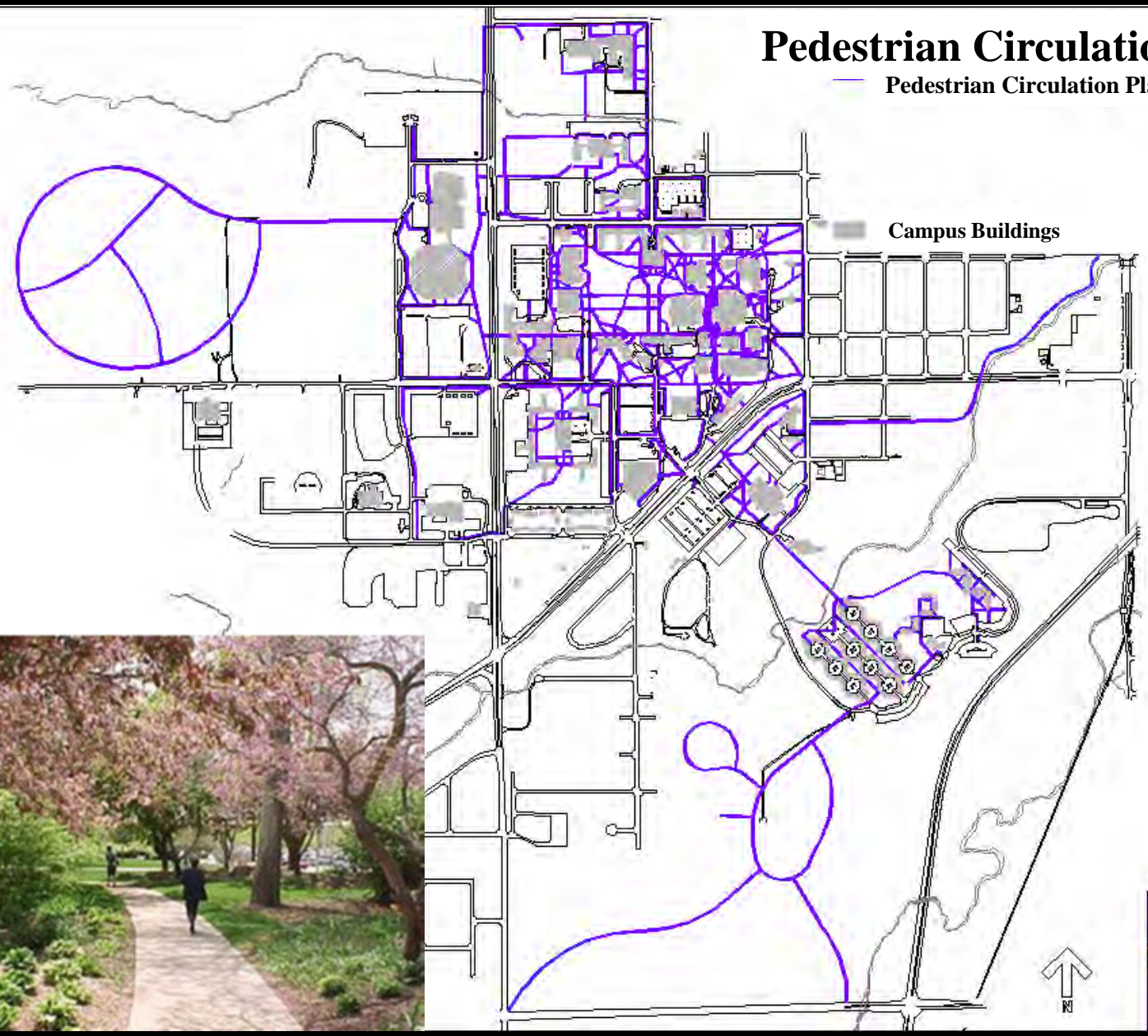

Campus Buildings

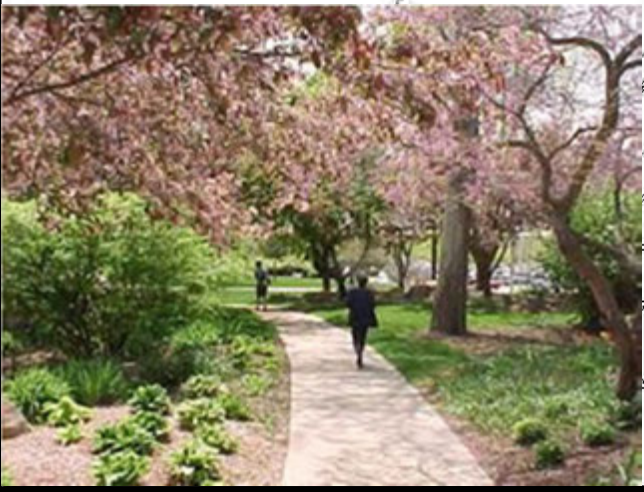

Pedestrian Circulation Plan

- Pedestrian Circulation Plan (long range)
- Pedestrian Circulation 2004

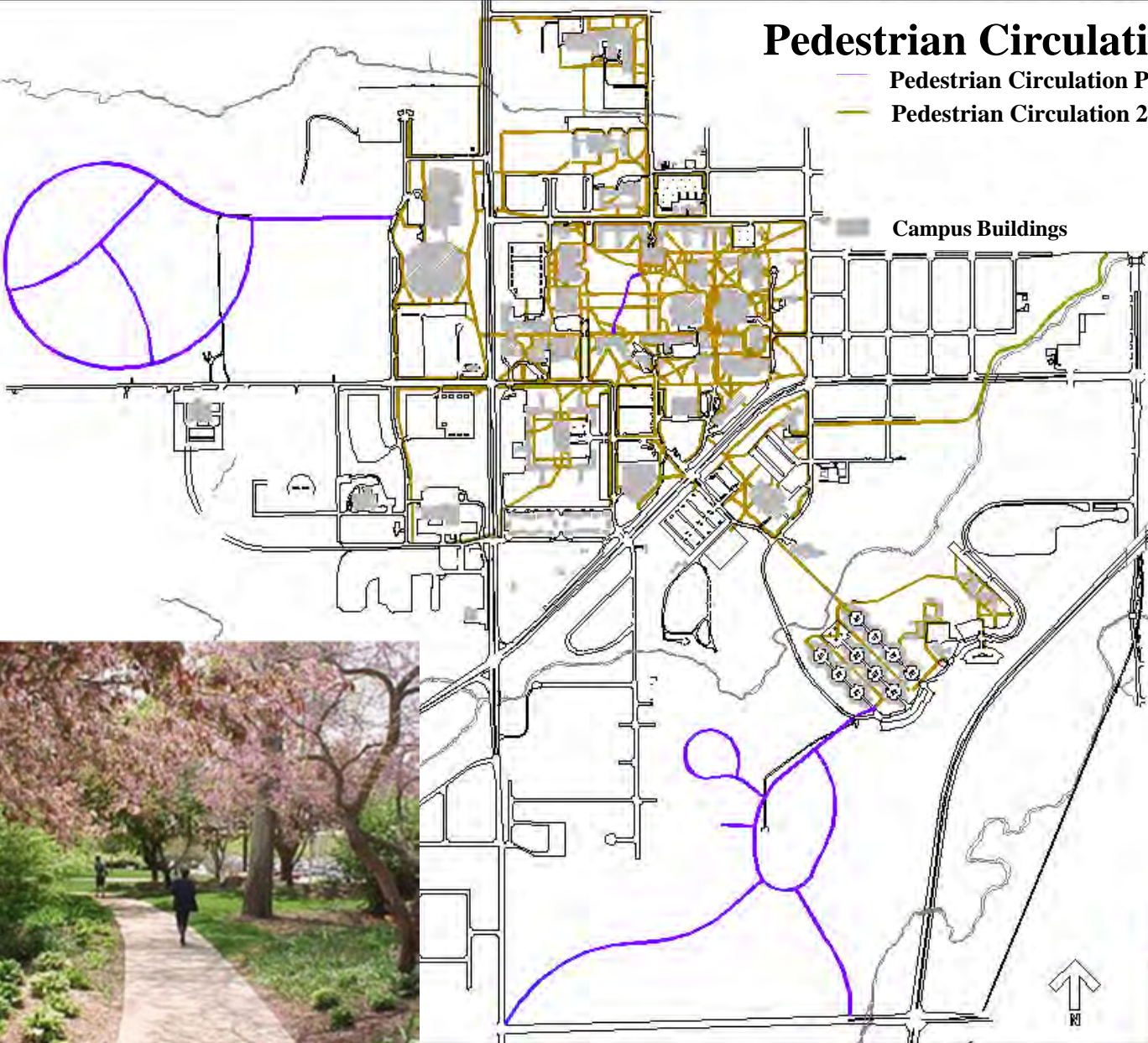

Pedestrian Circulation Plan

- Pedestrian Circulation Plan (long range)
- Pedestrian Circulation 2004
- Pedestrian Improvements since 2000

Campus Buildings

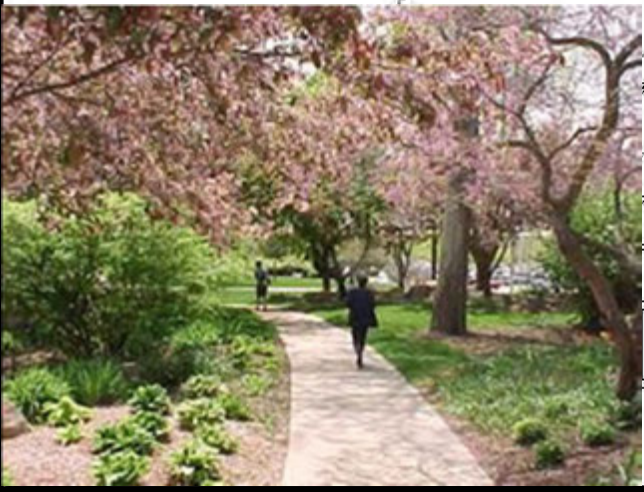
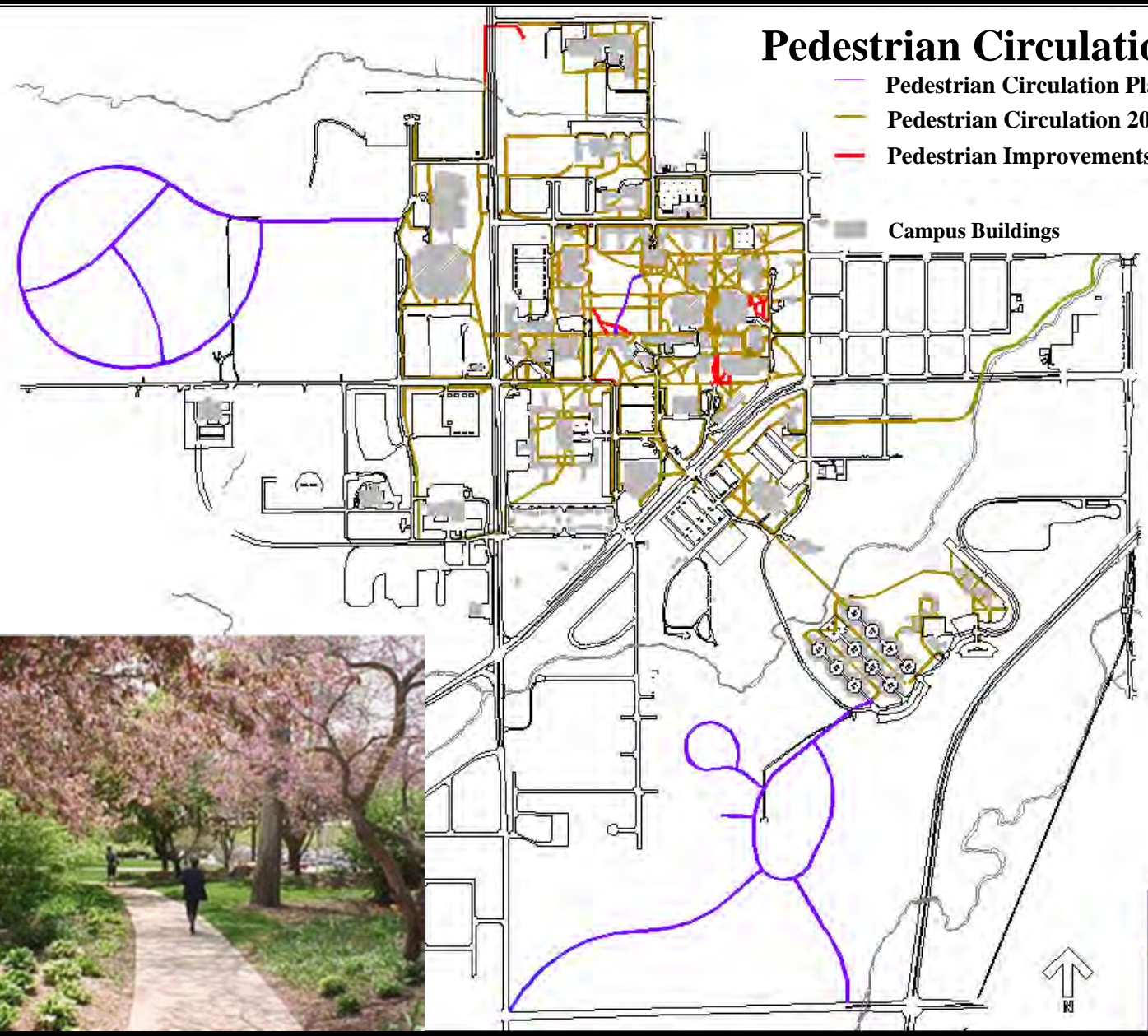

Long-Range Vehicular Circulation Plan

Vehicle Access Plan

— Vehicular Access Plan (long range)

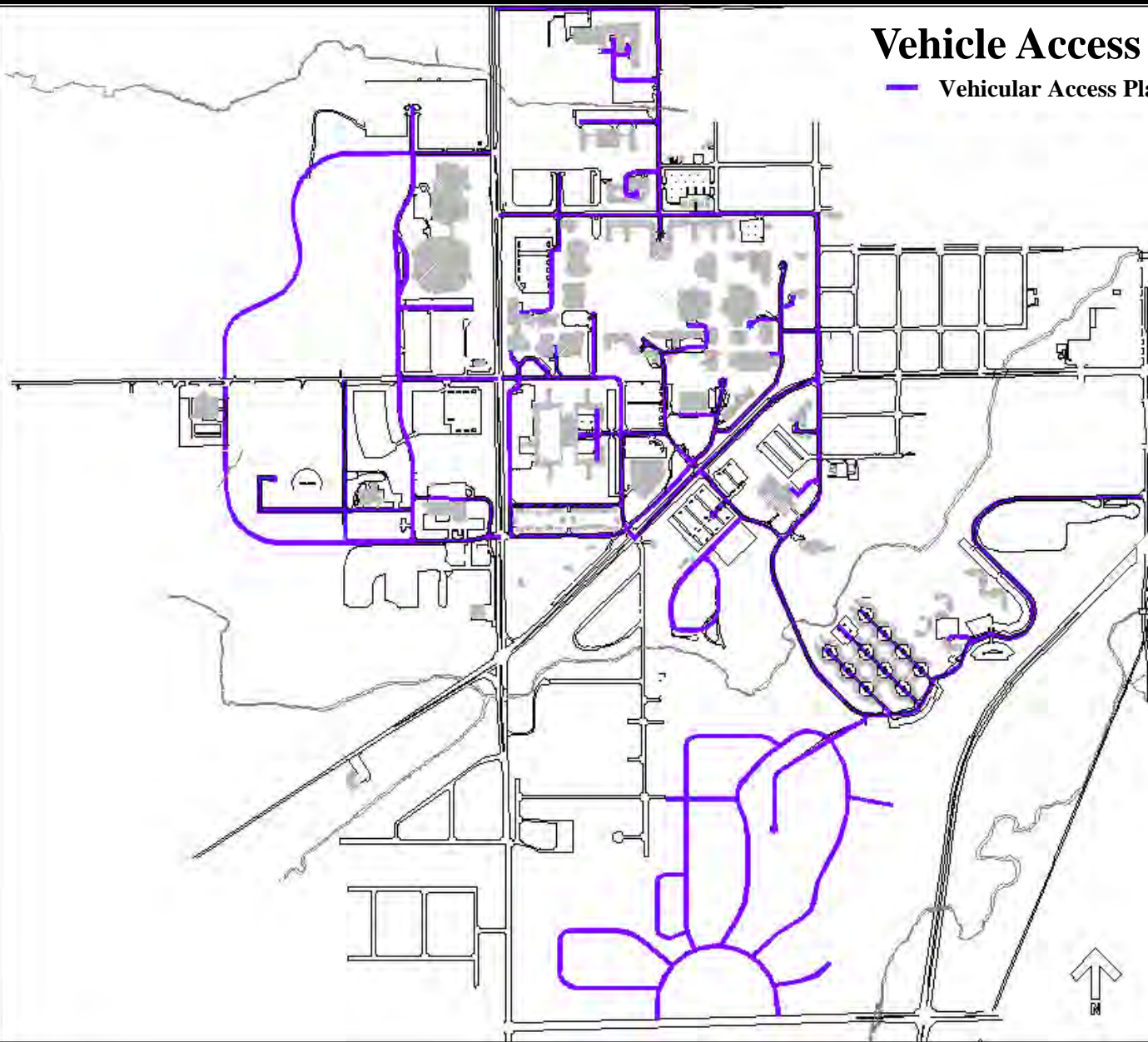

Vehicle Access Plan

-  Vehicular Access Plan (long range)
-  Existing Vehicular Access 2004

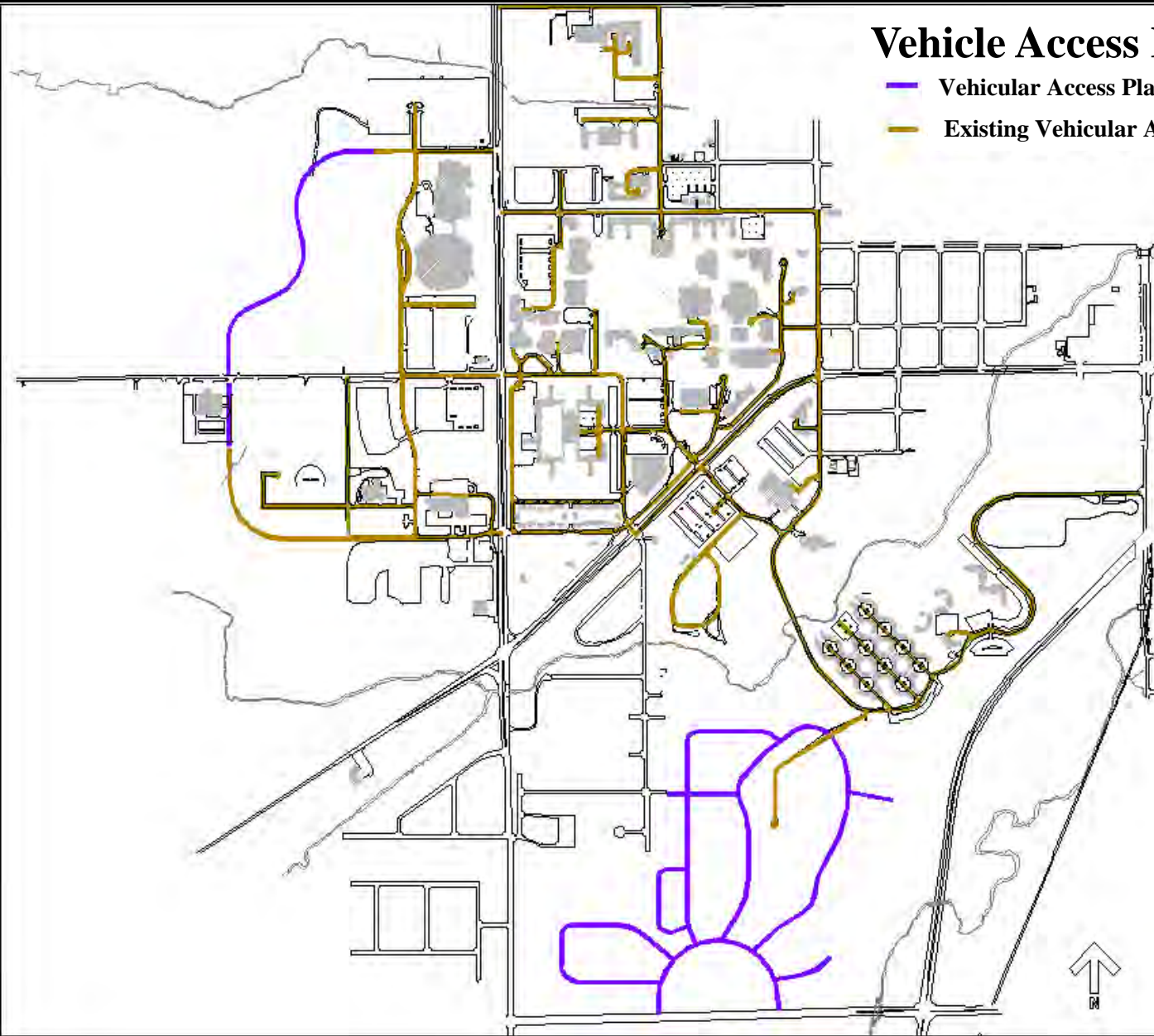

Vehicle Access Plan

- Vehicular Access Plan (long range)
- Existing Vehicular Access 2004
- Vehicular Access improvements since 2000

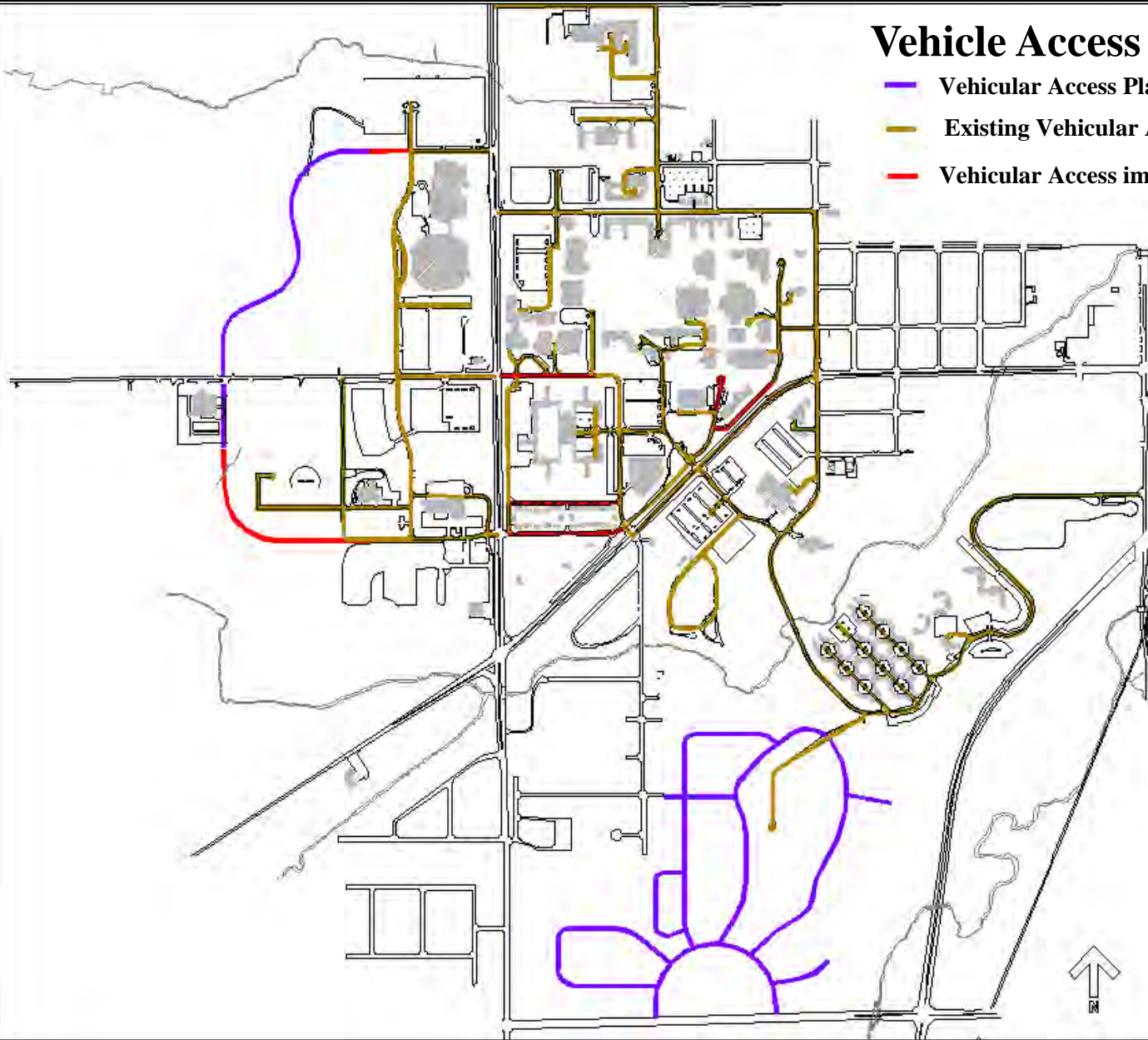

Long-Range Parking Plan

Parking Plan

■ Parking Plan (long range)

■ Campus Buildings

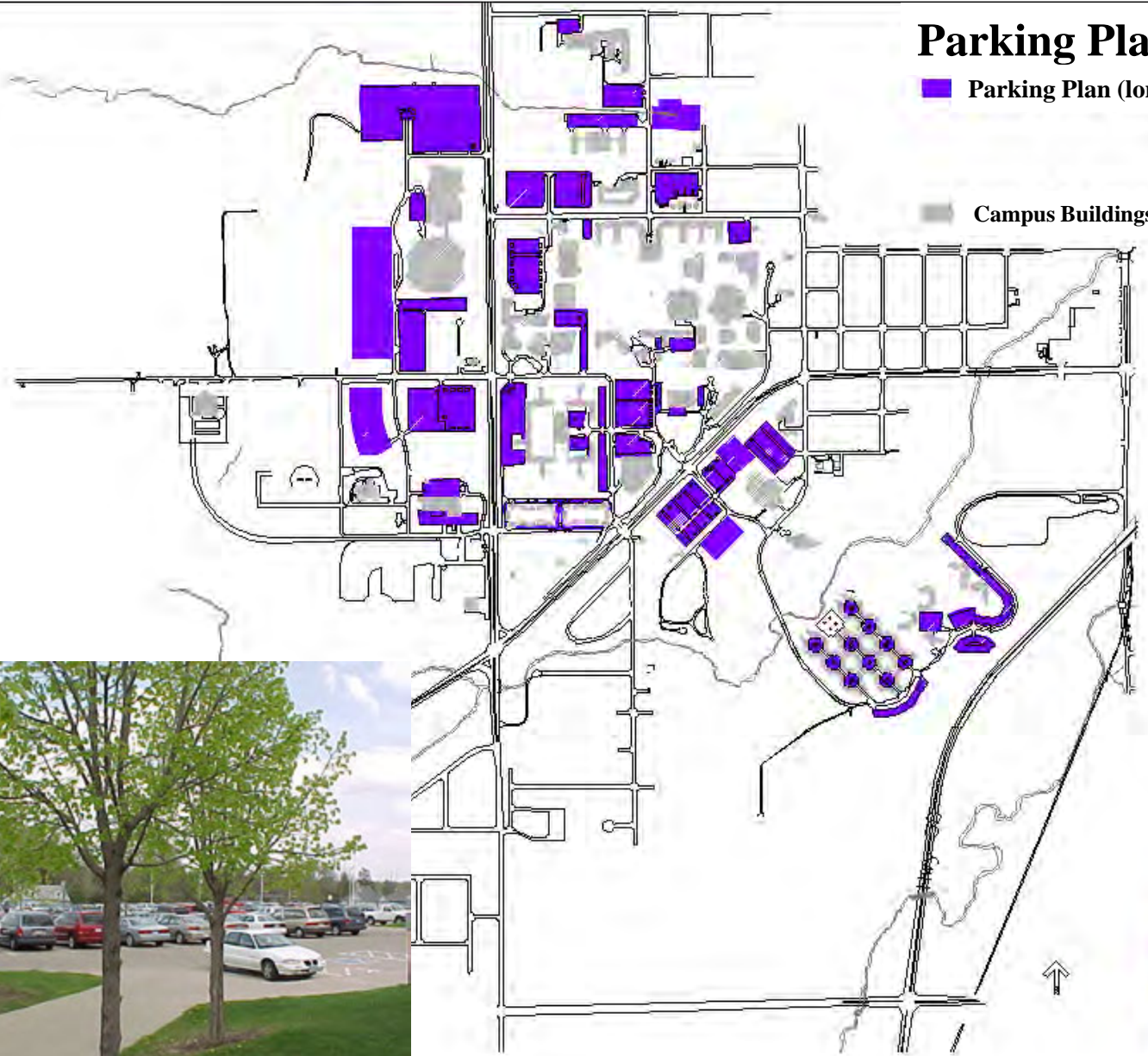

Parking Plan

- Parking Plan (long range)
- Parking 2004

 Campus Buildings

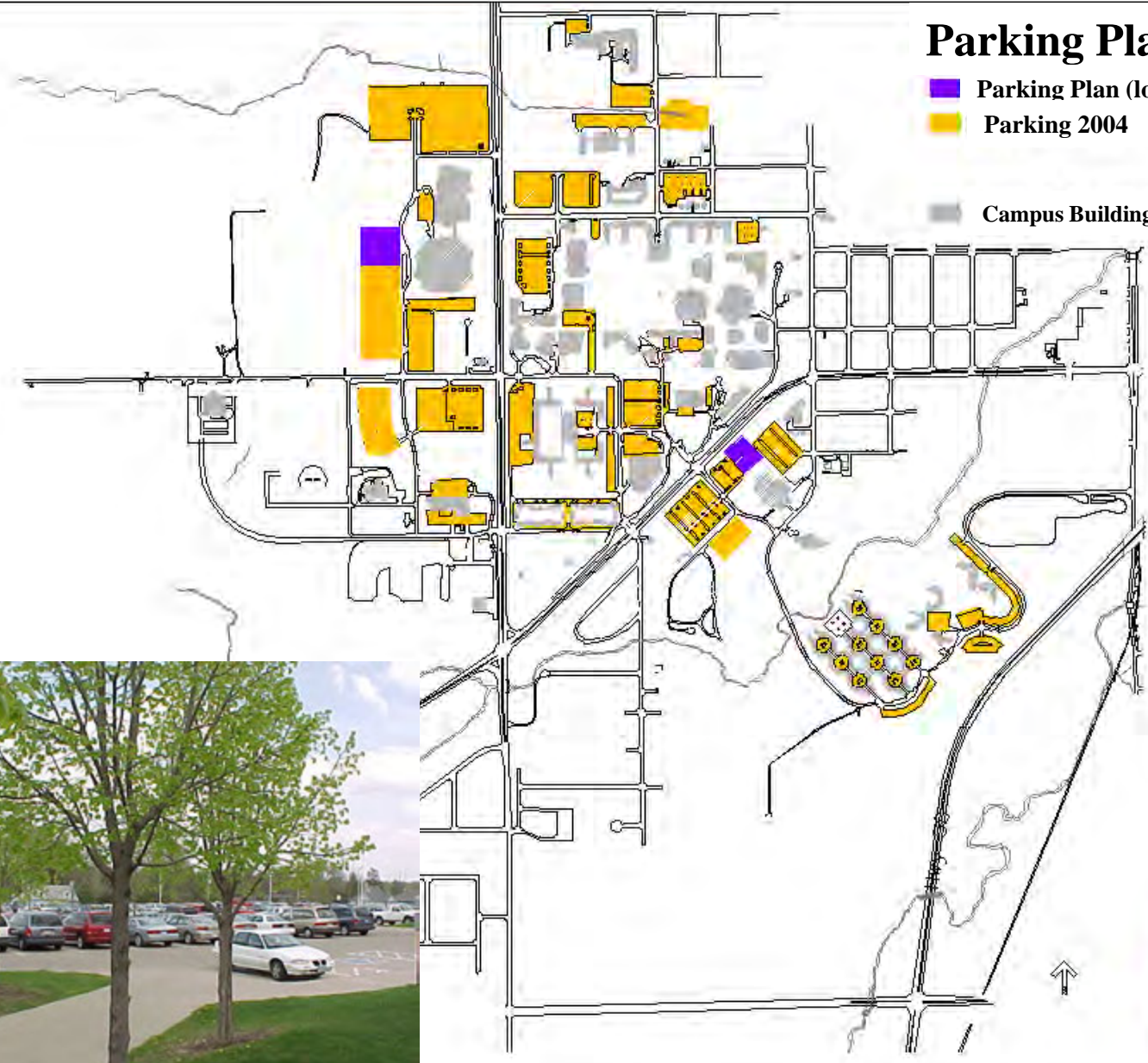

Parking Plan

- Parking Plan (long range)
- Parking 2004
- Parking added since 2000
- Campus Buildings

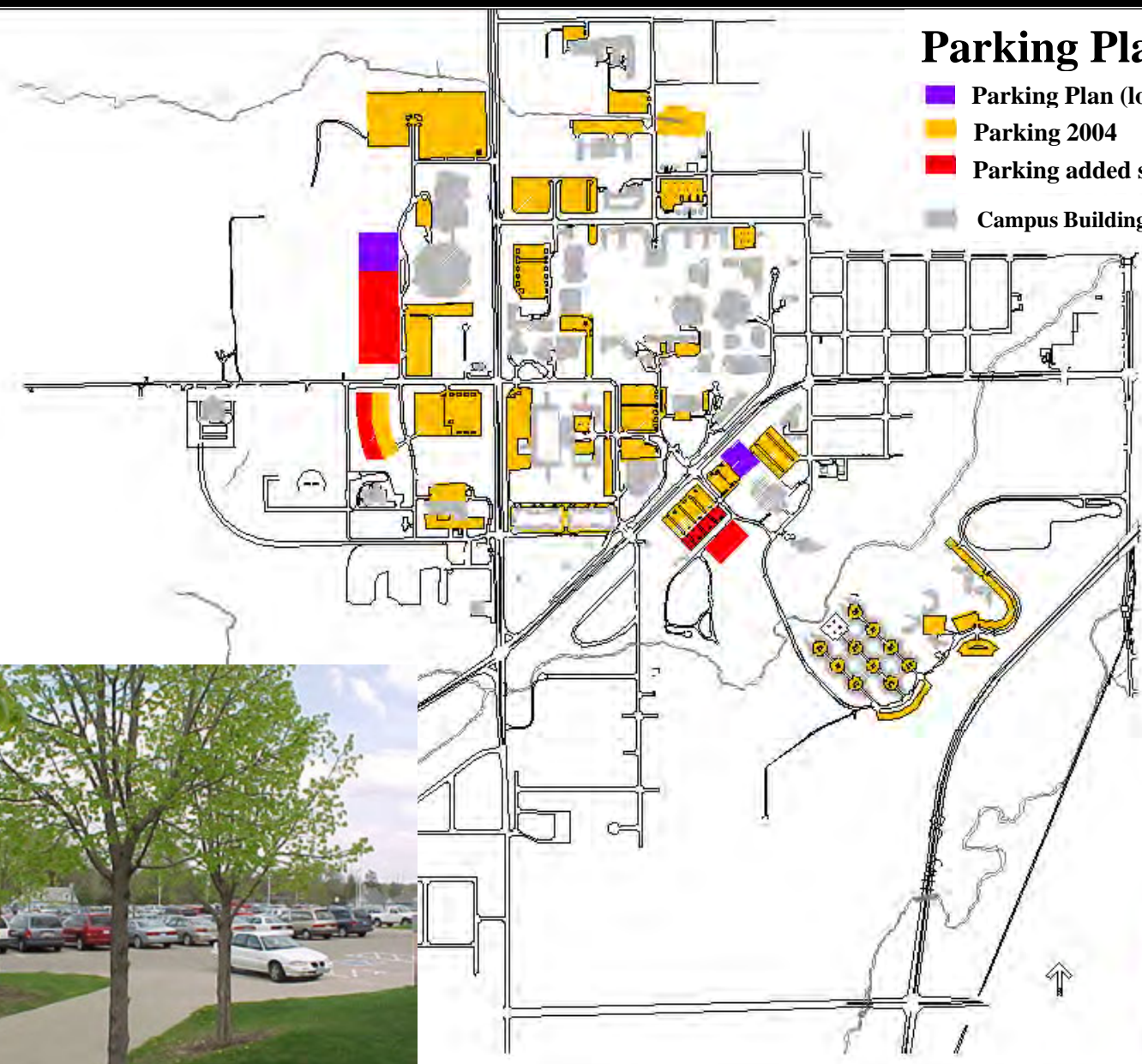

Long-Range Electrical Distribution Plan

Electrical Distribution Plan

— Electrical Distribution (long range)

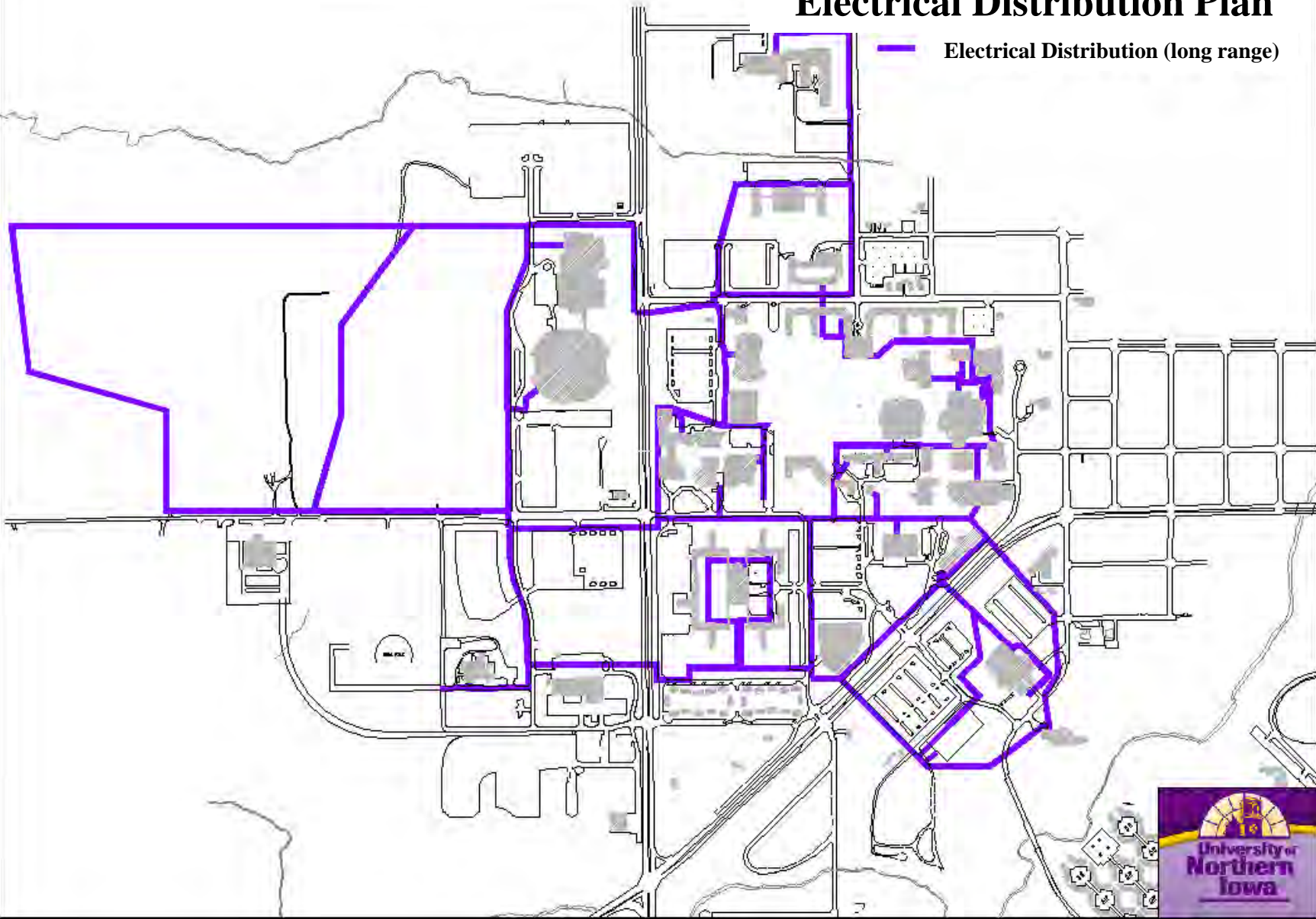

Electrical Distribution Plan

- Electrical Distribution (long range)
- Electrical Distribution system 2004

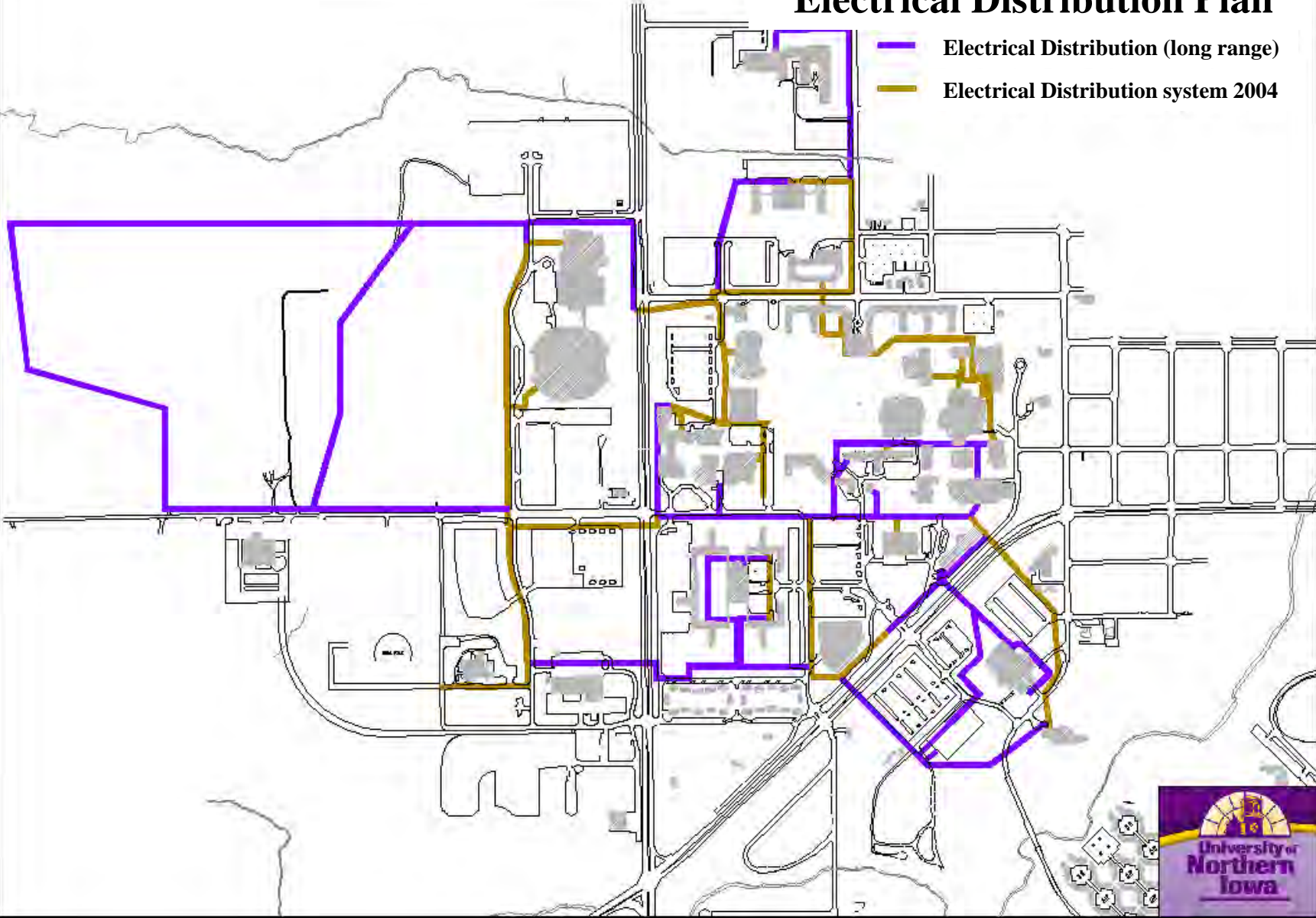

Electrical Distribution Plan

- Electrical Distribution (long range)
- Electrical Distribution system 2004
- Electrical Distribution system Improvements since 2000

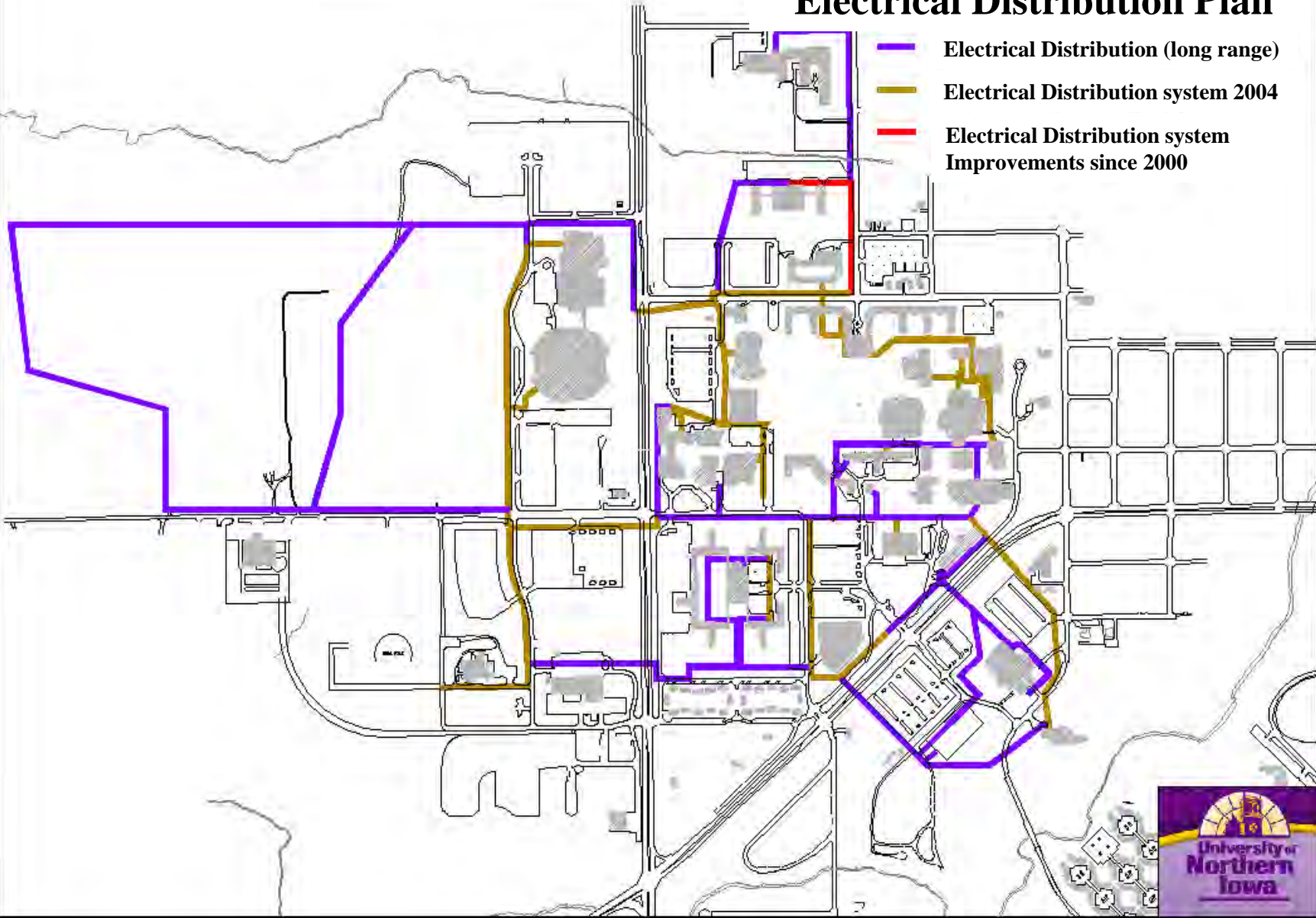

Long-Range Tunnel/Steam Distribution Plan

Steam Distribution Plan

— Steam Distribution (long range)

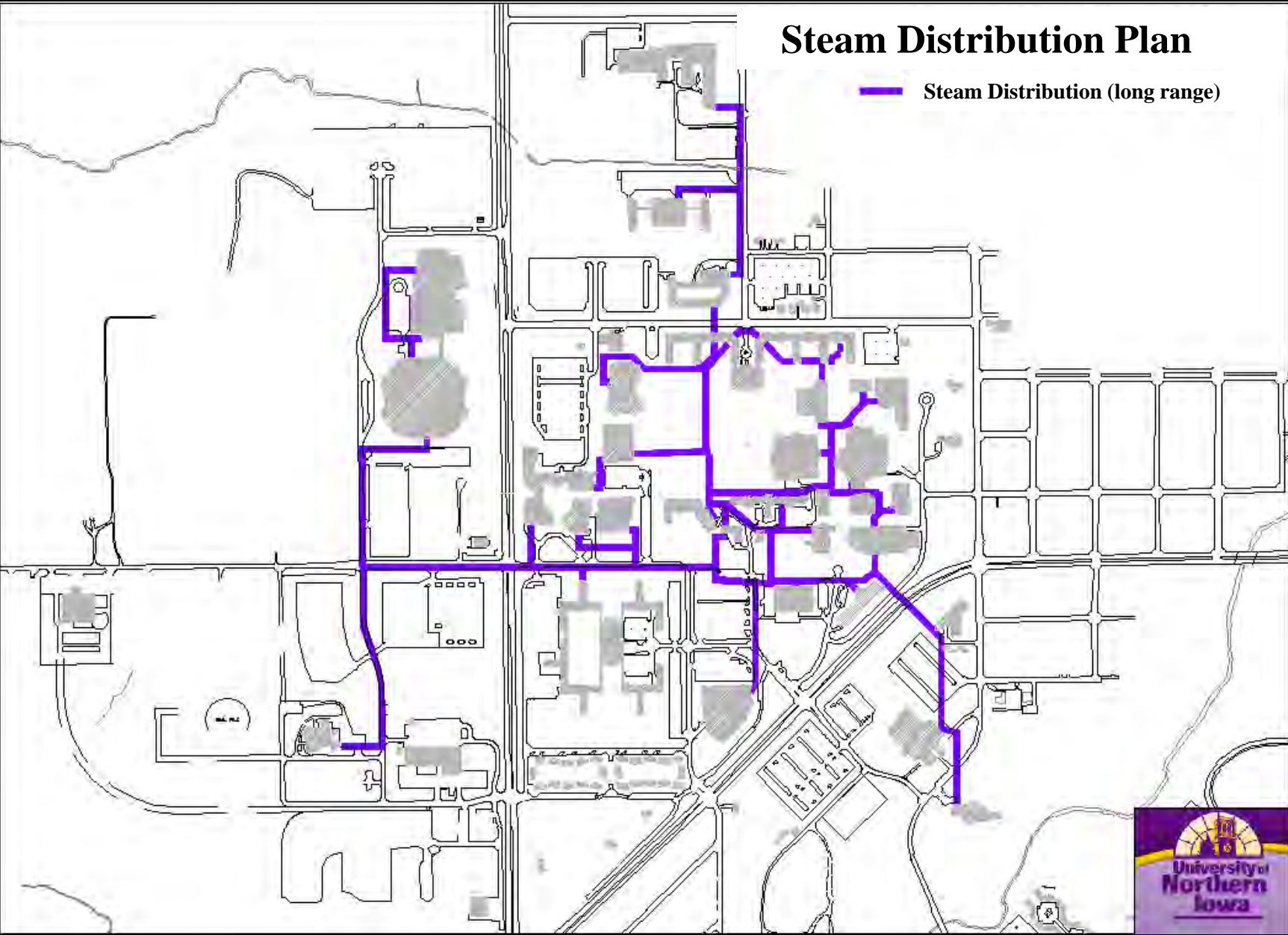

Steam Distribution Plan

- Steam Distribution (long range)
- Steam Distribution 2004

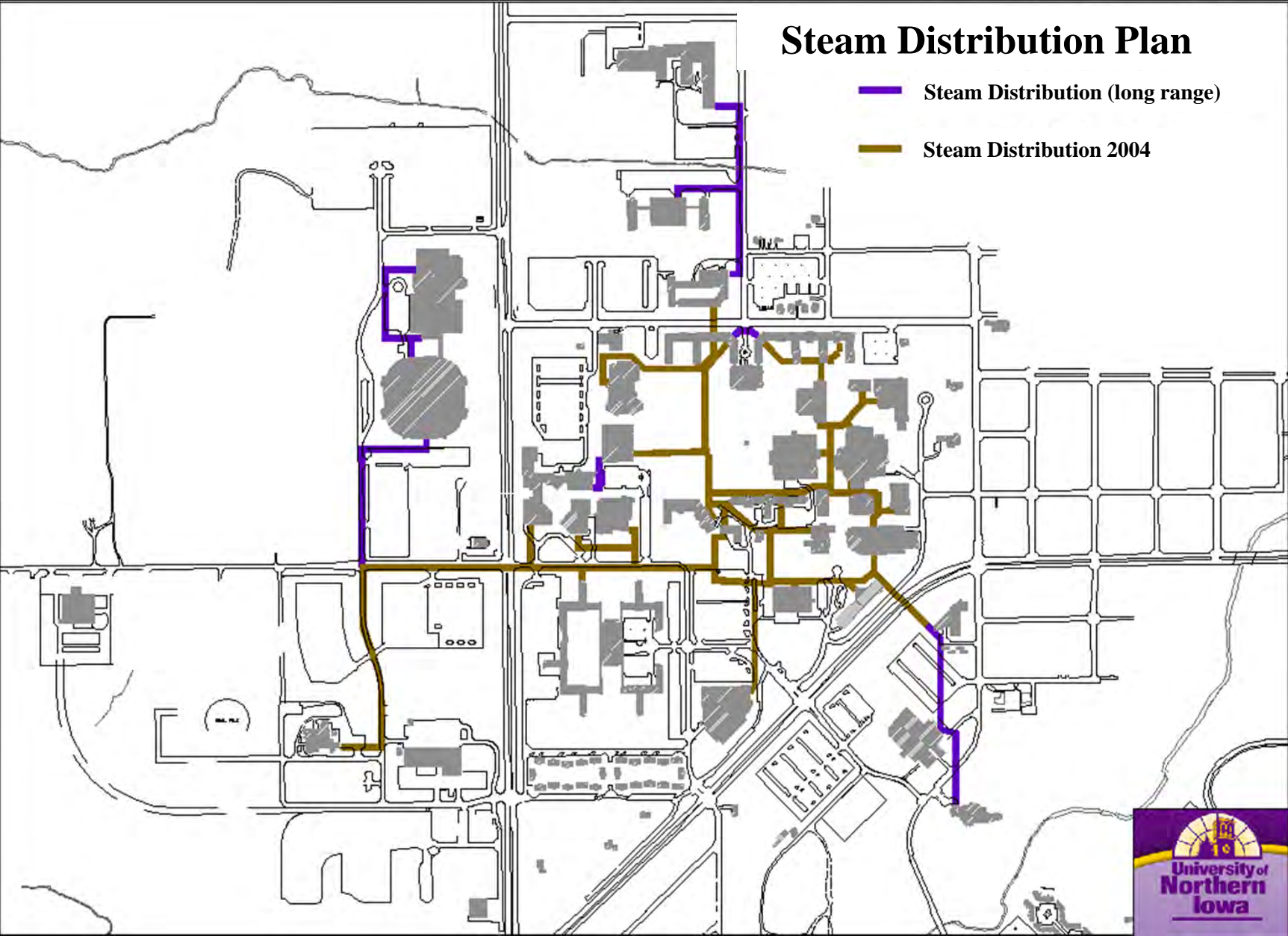

Steam Distribution Plan

- Steam Distribution (long range)
- Steam Distribution 2004
- Improvements since 2000

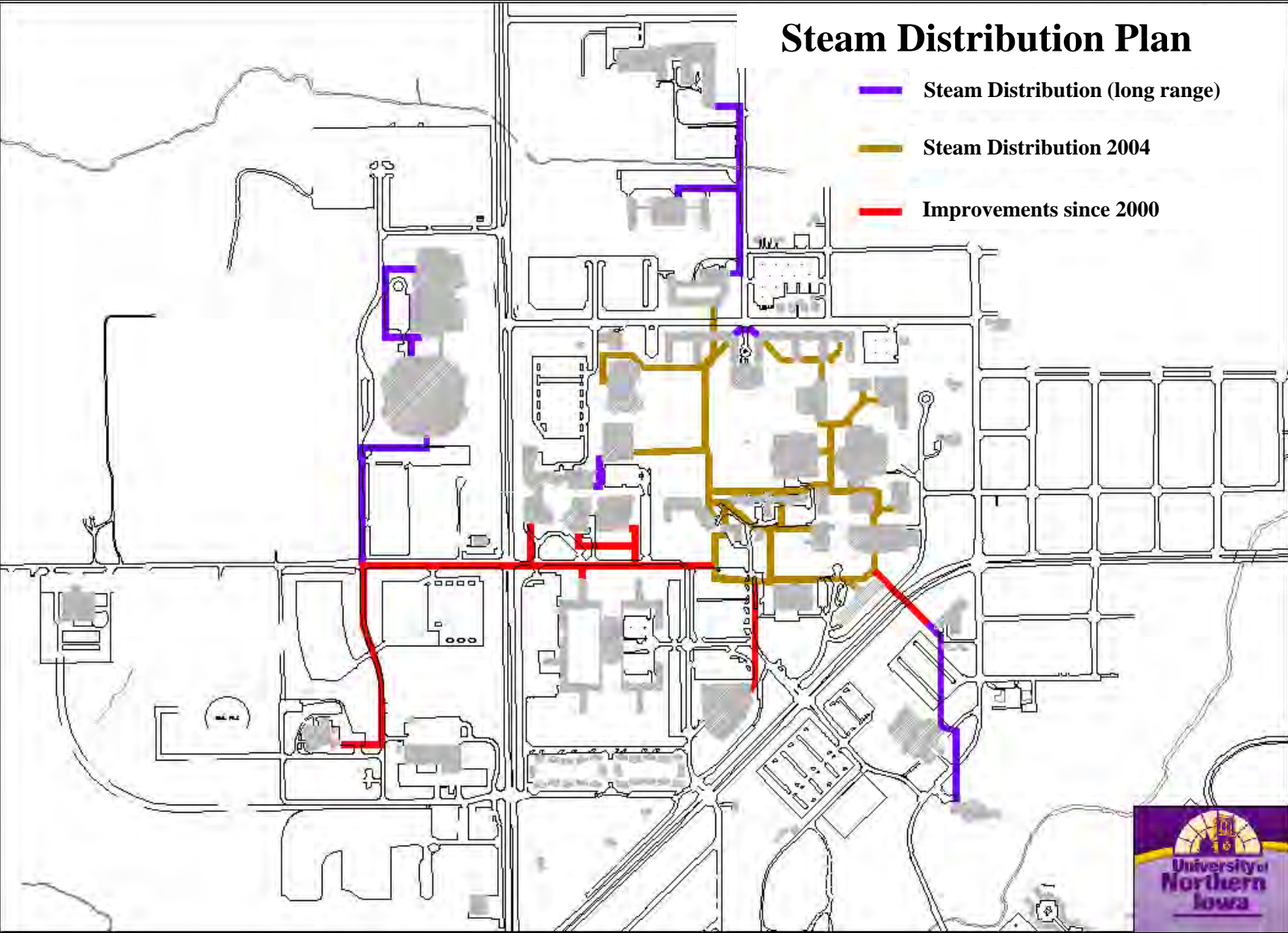

Major Capital Projects



Major Capital Projects

■ Completed since 2000

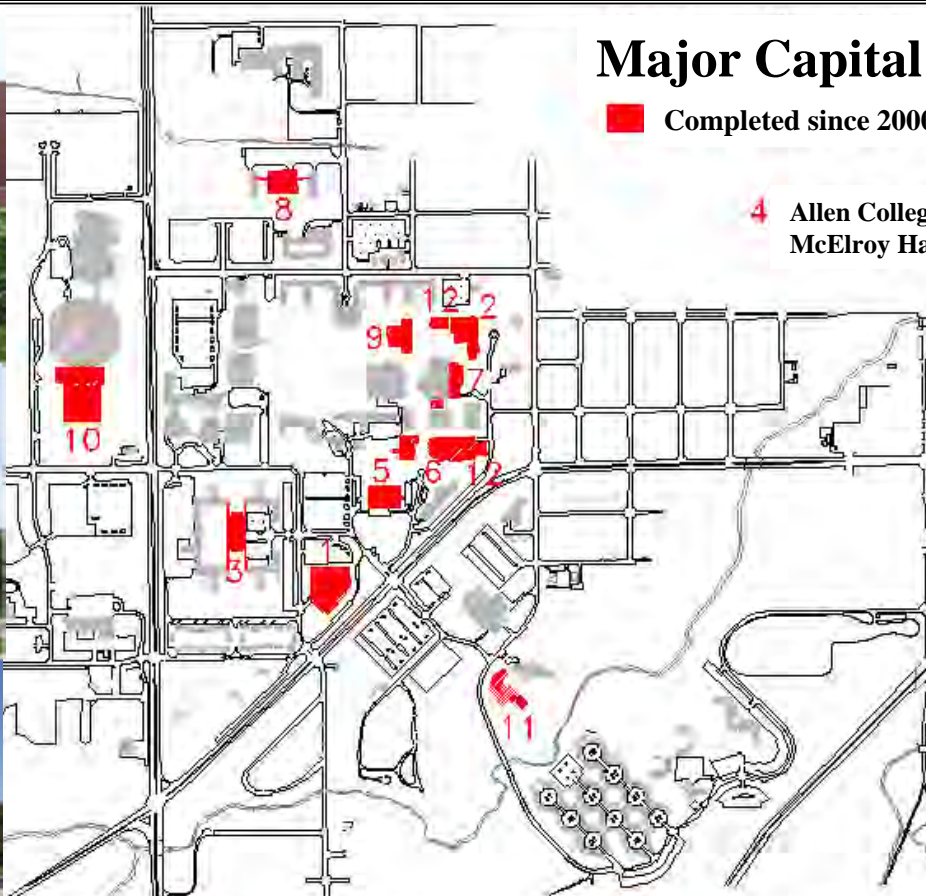

4 Allen College Campus
McElroy Hall

- | | |
|-----------------------------------------------------------------------|------------------------------------------------|
| 1 School of Music Classroom Building
Performing Arts Center (2000) | 7 Maucker Union Renovation (2004) |
| 2 Lang Hall Renovation (2001) | 8 Towers Dining Center (2004) |
| 3 Redeker Dining Center
Improvements (2004) | 9 ITTC (under construction) 2006 |
| 4 Early Childhood Development
Center (2004) | 10 McLeod Center (under construction) |
| 5 ISSC Gilchrist Hall (2004) | 11 Business and Community Services
Building |
| 6 McCollum Science Hall
Addition (2004) | 12 Science Building Renovations |



Building Envelope Major repairs Projects

Building envelope/major repair Projects

■ Completed since 2000

Buildings affected (33)

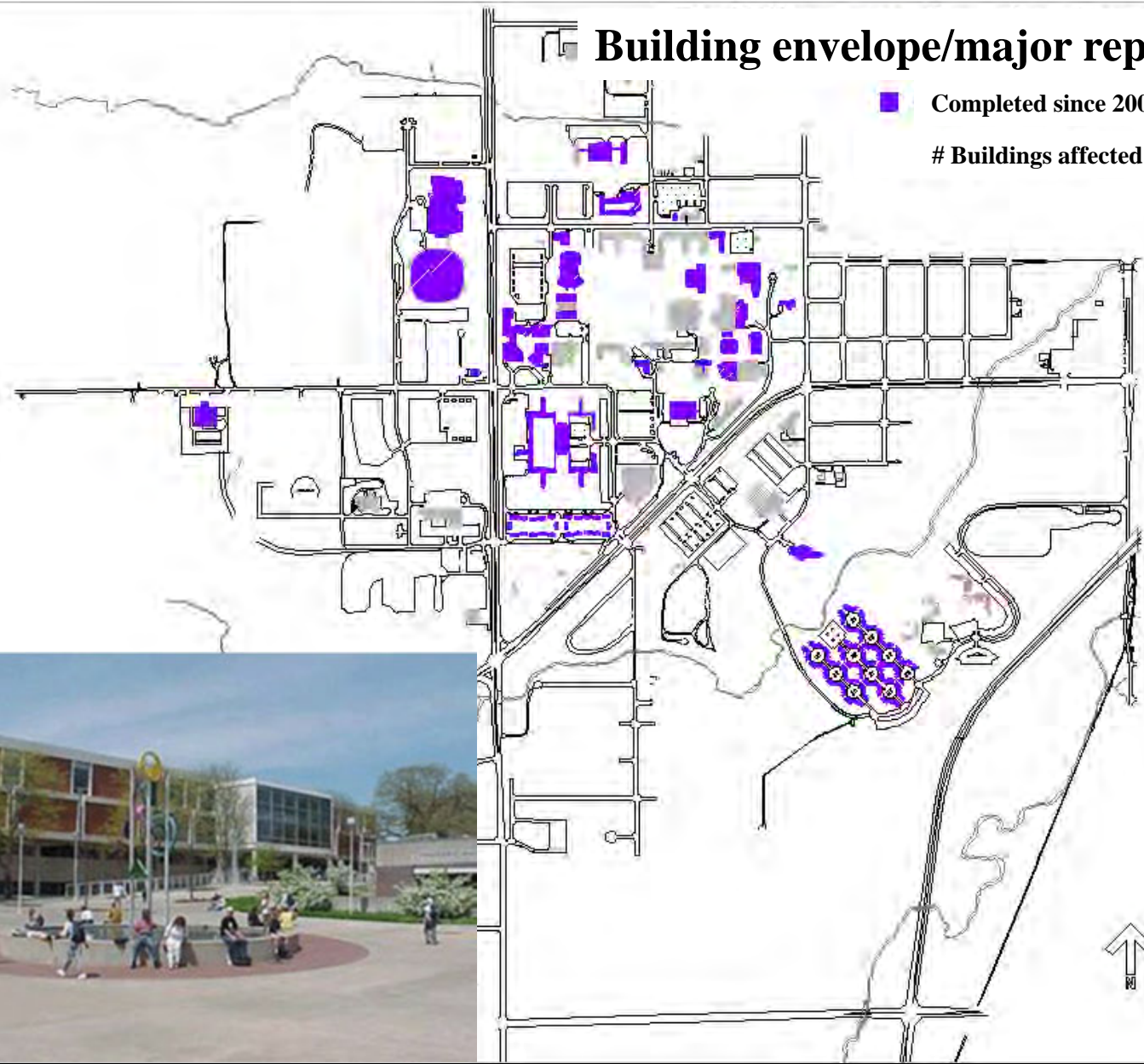

Board Approved 5 year
Capital Plan

Board approved 5 year Capital Plan

FY2006 campus wide deferred maintenance

FY2007 campus wide deferred maintenance



Board approved 5 year Capital Plan

FY2006 campus wide deferred maintenance

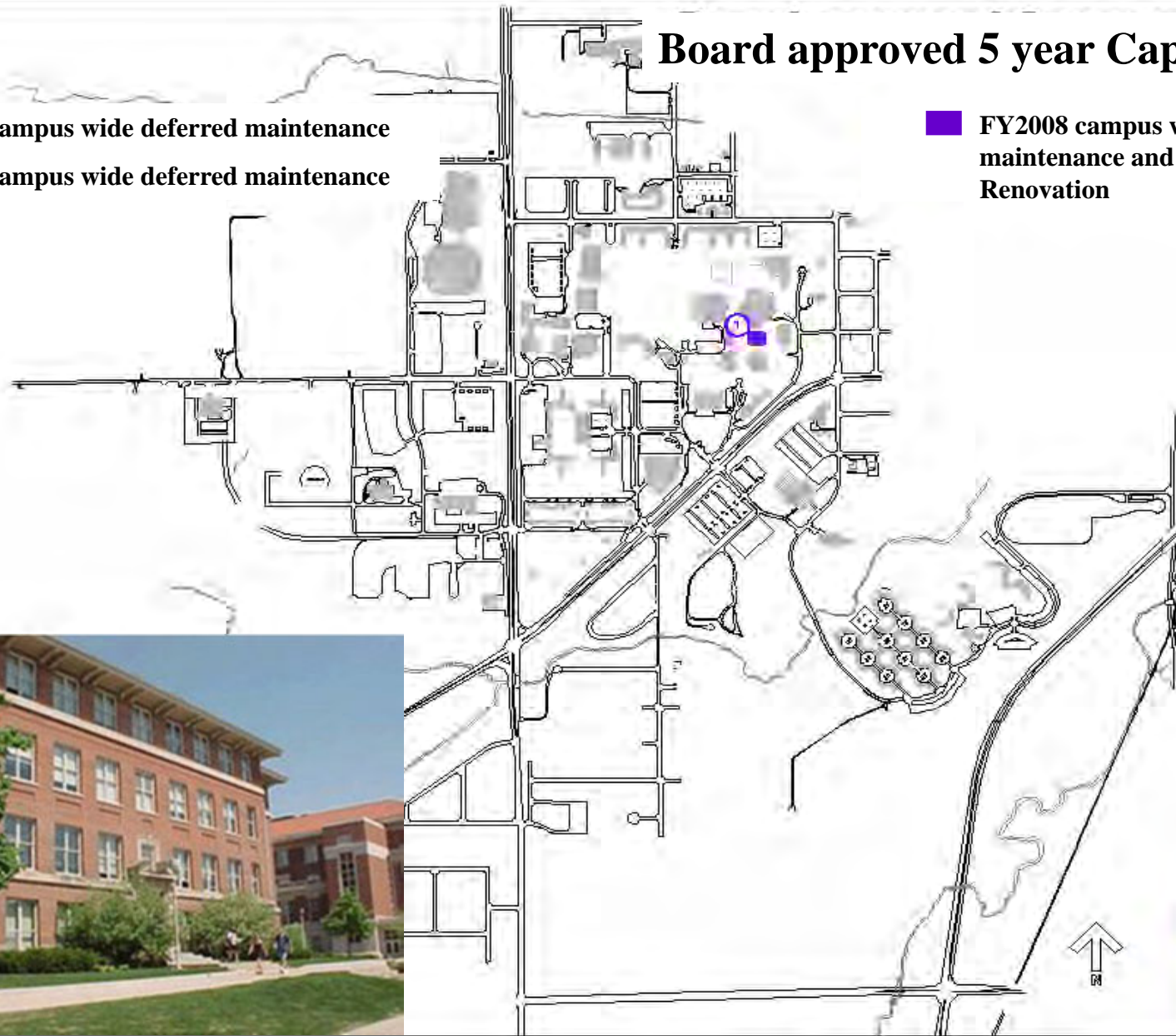

FY2007 campus wide deferred maintenance

 FY2008 campus wide deferred maintenance and Sabin Hall Renovation





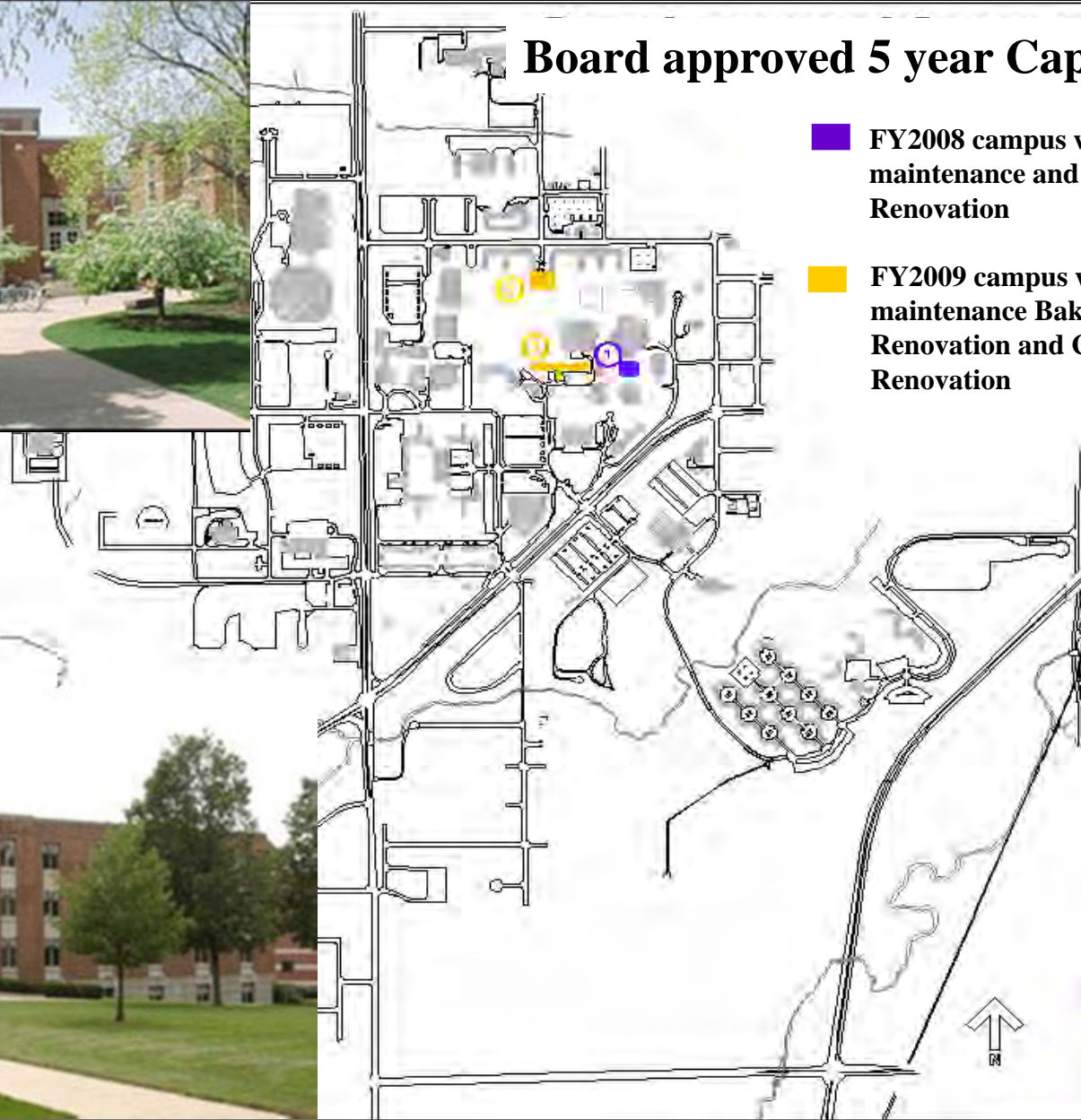

Board approved 5 year Capital Plan

-  FY2008 campus wide deferred maintenance and Sabin Hall Renovation
-  FY2009 campus wide deferred maintenance Baker Hall Renovation and Commons Renovation



Board approved 5 year Capital Plan

-  FY2008 campus wide deferred maintenance and Sabin Hall Renovation
-  FY2009 campus wide deferred maintenance Baker Hall Renovation and Commons Renovation
-  FY2010 campus wide deferred maintenance McCollum Science Hall Addition

